

LAND CORNER RECORD

5680-2

1. T 6S R 29E No. L-25 Cor. 1/4 Mer. W State Oregon (Rectangular) N. F. Umatilla Dist. Ukiah 24

2. Corner Status

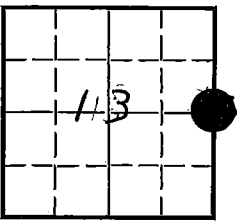

3. Original Description \_\_\_\_\_ Vol. \_\_\_\_\_ Page \_\_\_\_\_ Where Recorded \_\_\_\_\_

4. Description of Corners: Corner is a post from which:  
 a Pine 20" in dia. bears N. 79°W. 56 lks.  
 A Pine 28" in dia. bears East 23 lks.  
 ● See mon. file, Brass Cap,

7. Photo Identification

Photo No. E.B.I. 7-51  
 Ident. By: KRJ

5. Investigation Notes:

Sec. 13 B.T. 29 $\frac{1}{2}$ " Ponderosa pine, vigorous, painted red stripe around tree, and placed form 54-3 on tree.  
 Sec. 18 B.T. is dead and fallen, but scribing is visible in old catface. Post has been placed at approx. corner.

8. Plane Coordinate Position Data

State \_\_\_\_\_ Zone \_\_\_\_\_  
 X \_\_\_\_\_  
 Y \_\_\_\_\_  
 Estab. By \_\_\_\_\_  
 Field Book No. \_\_\_\_\_  
 Where Filed \_\_\_\_\_

9. Evaluation

Authentic \_\_\_\_\_  
 Needs Verif. \_\_\_\_\_ Monument No  
 Re-estab. X Survey \_\_\_\_\_  
 Land Status Public Domain

6. Signed Kenneth R. Johnson Forester Title \_\_\_\_\_ Date 6-3-65

PERPETUATION RECORD

10. Monument:

11. Accessories

Field Book \_\_\_\_\_ Page \_\_\_\_\_

12. Set By \_\_\_\_\_ Title \_\_\_\_\_

License \_\_\_\_\_ Agency \_\_\_\_\_ Date \_\_\_\_\_

13. Recorded By \_\_\_\_\_ Volume \_\_\_\_\_ Page \_\_\_\_\_

(Agency)

(Date) \_\_\_\_\_ (City) \_\_\_\_\_ (County) \_\_\_\_\_ (State) \_\_\_\_\_

14. Remarks:

L-25

Index  
File No. L-1

**CORNER RECORD (SEARCH)**  
(Ref. FSM 715T.4)

Tract or  
Survey No. \_\_\_\_\_ Cor.  
No. L-1

T 6S R. 30E R.D. NK19b County Morrow-Umatilla Co. Line

Merid. Wil. N.F. Umatilla State Oregon

CORNER DIAGRAM

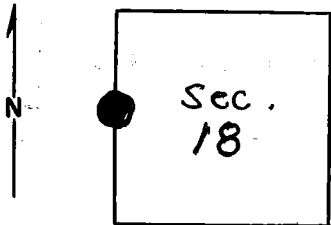

DESCRIBE CORNER MONUMENT FOUND

Brass Cap monument.  
see L-25, T.6S, R.29E, monumentation  
file.

2

DESCRIBE BEARING TREES OR OTHER OFFICIAL ACCESSORIES FOUND

3

DESCRIBE CORNER LOCATION RELATIVE TO NEAR-BY FEATURES, ALSO HOW TO REACH CORNER

PHOTO IDENTIFICATION DATA

Photo No. \_\_\_\_\_  
Filed At. \_\_\_\_\_  
Object Ident. \_\_\_\_\_  
Ident. By. \_\_\_\_\_  
*Signature*

6

7

PLANE COORDINATE POSITION DATA

State \_\_\_\_\_ Zone \_\_\_\_\_  
X \_\_\_\_\_  
Y \_\_\_\_\_  
Estab. By. \_\_\_\_\_  
*Agency*

8

Signature  
*F. Hollamon*

Title \_\_\_\_\_ Division \_\_\_\_\_ Headquarters \_\_\_\_\_

Date  
*1/75*

4

5

**CORNER RECORD (PERPETUATION)**

**MONUMENT: DESCRIBE NEW MONUMENT SET, OR WORK DONE TO PRESERVE EXISTING MONUMENT**

9

**ACCESSORIES : DESCRIBE NEW BT'S WITNESS OBJECTS ETC. ESTABLISHED, OR WORK DONE TO PRESERVE EXISTING EVIDENCE**

10

Work Done By \_\_\_\_\_ Title \_\_\_\_\_ Date \_\_\_\_\_ State Registration No. or Agency \_\_\_\_\_

Certified Cor. Record Prepared ? Yes No Filed At: \_\_\_\_\_ Date \_\_\_\_\_

11

**REMARKS**

12

Index File No. T. R. M. Tract or Surv. No. Cor. \_\_\_\_\_

13