

OREGON CORNER RESTORATION FORM

Section 25,30 Township 4N Range 37E W.M.
County Umatilla Date 8/1/93
CORNER DESIGNATION: T-25

Previous Renewals/Surveys, etc. The original survey was made by George S. Pershin under contract No. 304, dated Sept. 19th, 1879. He set a basalt stone 14 x 12 x 7 from which a fir, 22 ins. diam. brs. N.24°E., 38 lks. dist.

A fir, 11 ins. diam. brs. N.41°W., 27 lks. dist.

The corner was resurveyed by Otis O. Gould under special instructions, Group 234, dated 7/11/1939. He found a basalt stone 14 x 12 x 8 firmly set, marked 1/4 on W. face from which a fir, 28 ins. diam., brs. N.19 1/2°E., 38 lks. dist., marked 1/4 S 30 BT

A fir 18 ins. diam., brs N.45 1/2°W., 39 lks. dist., marks grown over. He set an iron post, 3 ft. long, 1 in. diam. 16 ins. in the ground to bed rock, with original stone deposited at the base, and a mound of stone to top for 1/4 Sec. Cor., with brass cap marked as indicated in the monument detail. He did not set any new accessories.

Monument(s) & Accessories Found: (Condition and Source) Found a 1' iron pipe with a brass cap marked as indicated in the monument detail. The monument is located on a steep North slope and was leaning down hill. We reset the monument in an upright position 16" in the ground and built a mound of stone to the top, from which,

A 24" fir with healed blaze and BT sign brs. N.39°W., 25.9 ft. to the center.

A 30" fir with healed blaze and BT sign brs. N.22°E., 26.2 ft. to the center.

A 12" spruce with a Boise Cascade location sign brs. N.20°E., 12.5 ft.

Monument Detail:

U.S. General Land Office Survey

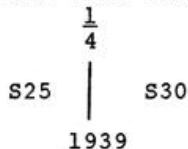

Monument Set (Procedures and Description): Maintained existing monument as noted in the monument & accessories found section.

New Accessories:

A 22" fir brs. S.57°E., 40.2 ft. marked T4N R38E S30 BT.

A 15" fir brs. S.59°W., 58.1 ft. marked T4N R37E S25 BT.

A steel fence post with Land Survey Marker sign attached brs. N. 3.0 ft.

Location & Comments: The corner is on a steep N. slope in thick timber about 800' north of Highway 204.

Compass Declination: 18° E
Firm/agency: Tomkins-Wells Joint Venture
Land Surveying
P.O. Box 1696
Pendleton, Oregon 97801

Party Chief: Greg Flowers
Notes: Greg Flowers
Witness: Todd Rosenbalm

Surveyor's Seal

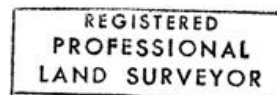

William R. Wells
OREGON
JULY 22, 1977
WILLIAM R. WELLS
1106

expires 12-31-94

93-64-C