

# OREGON CORNER RESTORATION FORM

SECTION 12 TOWNSHIP 4 NORTH RANGE 27 EAST J-25

COUNTY : UMATILLA DATE 10-2002

CORNER DESIGNATION

SOUTH EAST CORNER

- CONDITION REPORT ONLY
- NOT FOUND
- RENEWED
- UNCOVERED
- SURVEYED IN
- REFERENCED

PREVIOUS RENEWALS / SURVEYS, ETC.

ORIGINAL SURVEY BY HAFT IN 1860. CONTRACT #93.  
 DEPENDENT RESURVEY BY GOULD IN 1941.  
 KRUMBEIN SET 2 1/2" BRASS CAP IN 1974 SURVEY FOR LAMB-WESTON.  
 SURVEY: PARTITION PLAT # 1992-29 BY EDWARDS, HE SET 2 1/2" BRASS CAP  
 OVER GOULD'S 1941 BRASS CAP WHICH WAS 1.5 FEET BELOW SURFACE.

MONUMENTS AND ACCESSORIES FOUND: CONDITION AND SOURCE

FOUND 2 3/8" BRASS CAP 1.4" BELOW SURFACE OF GRAVEL ROAD STAMPED  
 AS BELOW, OVER GOULD'S BRASS CAP NOW ABOUT 2.5 FEET BELOW SURFACE.  
 FOUND 2 1/2" B.C. STAMPED 45 LK. 1941. BEARS N 44°16' E 29.90 FEET (29.7').  
 A 1 1/2" STEEL CHAIN LINK FENCE CORNER POST BEARS N 29°28' W 43.86 FEET.  
 AN ALUMINUM TAG #951 ON A R&R TIE FENCE POST BEARS S 51°08' E 40.32 FEET.  
 AN ALUMINUM TAG #951 ON A POWER POLE BEARS S 26°32' W 38.49 FEET.  
 FOUND 2 1/2" BRASS CAP STAMPED 1971 S 1°07'12" E 1.19 FEET.

MONUMENT DETAIL

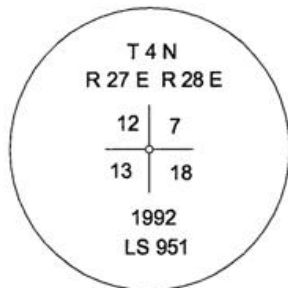

NAD 83/91  
 OREGON STATE PLANE  
 INTERNATIONAL FEET  
 792739.0170  
 8489493.6578



SKETCH

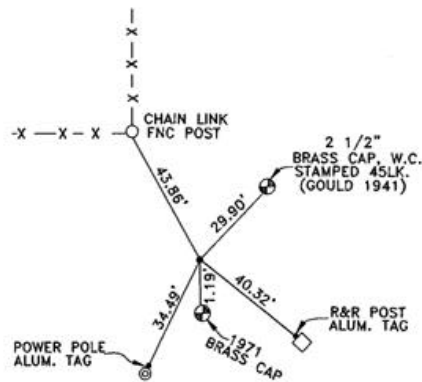

MONUMENT SET ( PROCEDURES AND DESCRIPTION )

NA

NEW ACCESSORIES FROM WHICH

NA

LOCATION AND COMMENTS

AT THE INTERSECTION OF WALKER  
 ROAD AND BRIDGE ROAD.

COMPASS DEC.

FIRM/AGENCY

EDWARDS SURVEYING  
 P.O. BOX 763  
 HERMISTON, OREGON 97838

PARTY CHIEF

CURTIS FAVOREL

NOTES

WITNESS

RICK SMITH

SURVEYOR'S SEAL

REGISTERED  
 PROFESSIONAL  
 LAND SURVEYOR

*G. Dennis Edwards*

OREGON  
 JULY 16, 1971  
 G. DENNIS EDWARDS  
 9 5 1

RENEWS 12/31/2003

03-50-9