

OREGON CORNER RESTORATION FORM

T1N R27E E1

Section 6, Township 1N, Range 27E,
County Morrow, Date January 31, 2005.

- Condition Report
- Not Found
- Remonumented
- Unrecorded
- Surveyed in
- Referenced out

Corner common to T1N, R26E, Sections 1 & 12 and
T1N, R27E, Sections 6 & 7, W.M., Morrow County,
Oregon.

Previous Renewals / Surveys, etc.

The corner was originally set by Ebenezer Haft under Contract No. 93 dated
September 11, 1860. His record Reads: Set post for corner to Secs 1, 12, 6 & 7 in
mound with trench and pits and deposited 1 pint of charcoal as per instructions.

Monument and accessories found: (Condition and source)
None. This position falls in the center of the County Road.

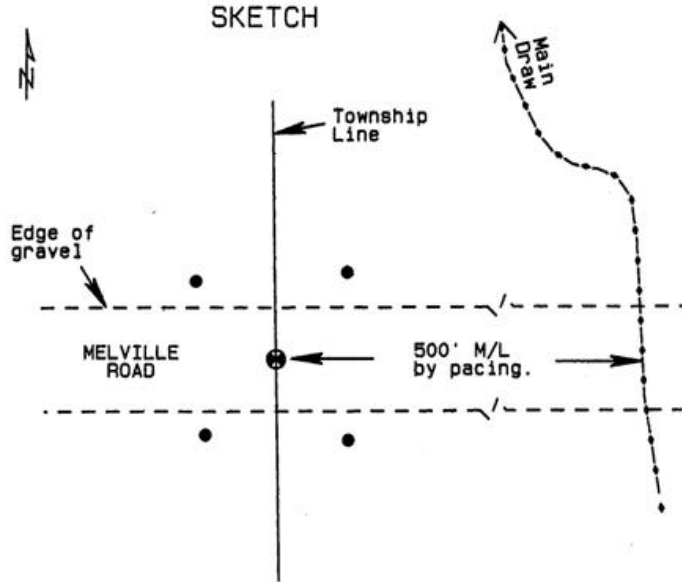
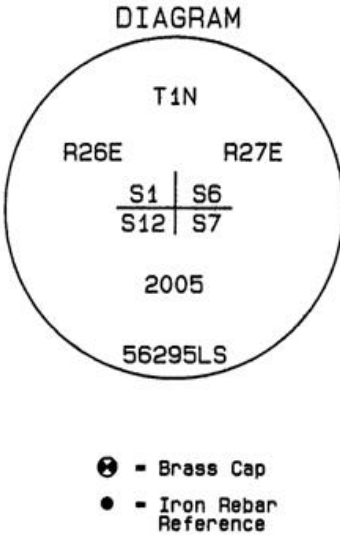

Monument and accessories set: (Procedures and description)

At the intersection of the Township line with the centerline of County Road 696
I set a 2 3/8" x 30" galvanized iron pipe with a 2 3/8" brass cap stamped as
shown above approximately 10" below the surface of the field.

For references I set four 5/8" x 24" iron rebars with 1.25" orange plastic caps
attached stamped WTS and 56295LS 24" below the surface of the field:

- an iron rebar bears N39°13'59"E 22.37 feet;
- an iron rebar bears N45°47'51"W 22.30 feet;
- an iron rebar bears S42°55'44"W 20.59 feet;
- an iron rebar bears S42°04'11"E 21.63 feet;

The monument and references were tied with a Trimble R7/R8 GPS system using
static surveying procedures. Bearings and distances are grid.

Location and Comments
SPC Oregon North, NAD 83-91
Northing = 702,284.13 ift
Easting = 8,458,536.74 ift

Compass Declination

Surveyor's Seal

Witnessed By:
RECEIVED BY:
Umatilla County Surveyor
Date: 5-05
Rec'd By: KK
No. 05-111-C

Firm / Agency
Witness Tree Surveying
P.O. Box G
Pilot Rock, OR 97868
Party Chief
Stephen K. Haddock, PLS

REGISTERED
PROFESSIONAL
LAND SURVEYOR

Stephen K. Haddock

OREGON
JULY 9, 2001
STEPHEN K. HADDOCK
56295LS

RENEWAL DATE 6-30-05