

RC No

Road No. 344,

344.

Report of viewers, Field notes and plat of survey of County Road No 345 in Umatilla County Or.
 Commencing on the county road about one hundred^{and} fifty yard south of the SW corner of the North East quarter of Section fourteen Township five North Range 32E. Thence to the South east corner of the North west quarter of said section Thence North on the line (or as near as practicable) to the South west corner of the Southeast quarter of Section Eleven (11) T 5 NR. 32E, Thence West on the line to the South east corner of Section ten (10) T 5 NR. 32E, Thence north on the line to a certain gulch or draw about one quarter of a mile, thence down said draw in a northeasterly direction to intersect the County Road running down North Juniper. Said Road to be sixty feet wide.

Report of Viewers on Road No 344,

In the matter of viewing, surveying and laying out County Road No 344.

To the Honorable County Court of the State of Oregon for Umatilla County:

We, the undersigned, the viewers heretofore appointed to view and locate Road No 344 submit the following report:-

Pursuant to the order of the Honorable Court we met Geo. B. Arnold, Surveyor, at A. B. Renicks house on August 4th A.D. 1890, and were by him, each, duly sworn to faithfully and impartially discharge the duties of our appointments, We called to our aid,

Geo. L. Stockman^{and} } Chainmen
 Edgar Thomson }

Geo. L. Stockman and Edgar Thomson Markers, who were by the Surveyor, each duly sworn. We viewed, and located said Road No 344 as specified in our order we find the road on good ground and badly needed, we would therefore recommend that said road No 344 be declared a public highway.

Geo. B. Colark
 John L. Stockman

Filed Aug. 19th 1890
 W. M. Pierce Clerk

Field Notes of Road Survey No 344 for
Umatilla County Oregon,

I meet Jno. L. Stockman and Geo. B. Clark viewers at A. B. Reicks house Aug 4 1890. We call Edgar Thomson and Jno. L. Stockman to chain and mark; each viewer & assistant was sworn according to law in such case provided. (Initial Post set 30' East of point of commencing.)

I commence 618 ft south of accepted center of Sec 14 T5 NR 32 E and run along fence purporting to be on 1/2 sec line, Ascend. Var 22° E.

- North
- 618 Center Sec 14 T5 NR 32 E.
- 800 Summit.
- 1200 Head of Ravine SE
- 2300 Set angle post by wire fence N S and turn thence
- N 75° 45' W 2635 " " " and turn right 78° 10'
- N 2° 25' E 3350 " " " " left 54° 48'
- N 54° 23' W 3671 Int. Sec line bet. secs 11 + 14 about 30 rods W of sec cor.
Set angle post by wire E + W and turn on sec line.
- West
- 4000 Descend.
- 5280 Set 1 m post 30' South of line in Isaac Atkinson's field
- 178 Ravine NW. Ascend.
- 387 Summit.
- 487 Cor to secs 10-11-14+15. Set angle post at cor and turn on line bet secs 10 + 11. Var 22°
- North
- 850 Foot of descent
- 2050 Set angle post by N + S fence and turn down ravine.
- N 25° 12' E 4481 " " " 13' N of traveled road NW SE and turn
- N 28° 20' W 5007 " " " do " "
- N 87° 04' W 5280 " 2 m. post 30' West of line.
- 300 Set angle post and turn 22° 15' left.
- S 70° 41' W 650 Int line bet Secs 10 + 11. Set angle post and turn on sec line.
- North
- 1183 Old road post on south bank of Juniper Canon 85 yards N. E. of School House. Road up and down Canon. I set Lermicus 30 ft. E on N side of road in lane E + W.

Thursday Aug 5th 1890

I hereby certify that the foregoing are the correct notes of Road Survey No 344 for Umatilla County Oregon.

Jno. L. Arnold
Surveyor.

Filed Aug. 19th 1890
W. M. Pierce Clerk.

B. Reicks
and prof
assistant
ided.

14 7 5 NR
Ascend, Var 22° E.

con

on line

ine.

see line,
to N. E. of School
ft. E on N

t notes of

Plat of Road No. 344

TOWNSHIP 5 N RANGE 32 E W. M.

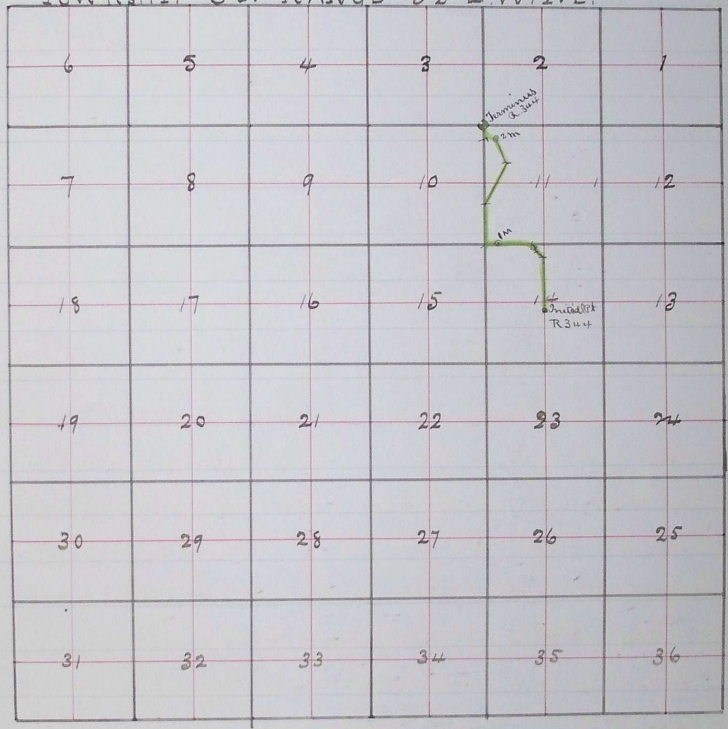

I hereby certify that the foregoing plat of
Road survey No 344 for Umatilla County
Oregon is correct.

Jno. G. Arnold. Surveyor

Filed Aug 19 1890
W. M. Pierce Clerk. No 12 1890 P 626