

PLAT AND RECORD OF SURVEY No. 7119

Survey for M. Patton

March 9th 1885

Subdivision of Sec. 10. T. 3 N. R. 29. Marking off the East half of section. Sworn Chairmen { G. M. Armstrong  
R. L. McMillen

Begin at the S.W. corner of sec 10 and the stake at the S.E. corner being visible with the transit I run on direct line

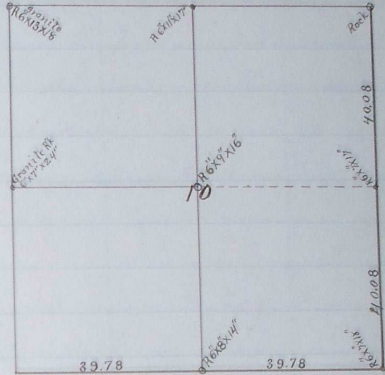

40 00 set temp stake, find no signs of original corner here

79 56 original cor at S.E. cor of sec 10

I run this corner by setting Rock 6"x7"x8" with charcoal under it. Thence West on true line

39 78 set Rock 6"x14" with pieces of porcelain underneath for 1/4 S bet Secs 10 and 15. From S.E. cor of sec 10 I run on direct line

40 00 set temp post

80 15 Come upon rock set at the N.E. corner of sec. 10. Thence on direct line

40 02 Set Rock 6"x6"x15 over a Warrastashire bottle for 1/4 S between Secs 10 and 11. From the rock at the N.E. cor of sec. 10 trace line West and find original quarter cor between Secs 10 and 3 which renew by setting a rock 6"x11"x14 with pieces of porcelain underneath.

Thence I run West to the original cor to Secs 3, 4, 9 and 10 which I renew by setting granite rock 6"x13"x18".

Thence South to the original, quarter corner bet Secs 9 & 10 which I renew by setting <sup>granite</sup> Rock 6"x7"x24" over pieces of porcelain. I now run straight lines across sec 10 between the opposite quarter section <sup>corners</sup> North and South East and West and place a rock 6"x9"x16" over pieces of Porcelain at their intersection for a 1/4 S at the center of section.

I hereby certify that the several angles of the subdivision of sec 10 are as shown on this page as correct. P. Deussen Light Co. Surveyor

East  
West  
North  
South