

PLAT AND RECORD OF SURVEY No. 19

Aaron Isaac

after Qualifying W. B. Isaacs and Peter Nelson according to law & proceed to Survey the land of Aaron Isaac to wit<sup>D</sup> Situated in Sec 9 T5. N R 35 E Commencing at the corner of 9.10.15 & 16 from which we run

- 85 00 to S.W. corner of sec 9 from which corner we run on random
- 42 50 Set Post for 1/4 corner from which we run
- 6000 Set <sup>Stone 20x14x14 in</sup> N.E. corner there
- 20 75 Set Post for N.W. corner there
- 20 00 Set Stone 12x6x6x for corner to Ell

T. 5 N. R. 35 E. of W. M.

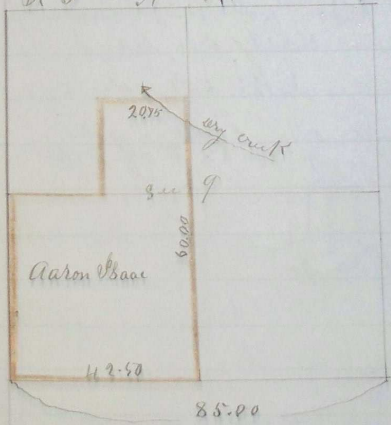

I hereby certify that the above is a true and correct plat and survey of Aaron Isaac land surveyed by me this 17<sup>th</sup> day of Sept. 1883

A. L. Coffey  
County Surveyor for  
Washtilla Co., Oregon