

Index
File No. Z-21

CORNER RECORD (SEARCH)

(Ref. FSM 7151.4)

Tract or
Survey No. _____ Cor.
No. _____

T 6N ~~5N~~ R. 38E

R.D. Walla Walla County Umatilla

Merid. Willamette

N.F. Umatilla State Oregon

CORNER DIAGRAM

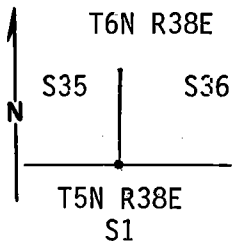

DESCRIBE CORNER MONUMENT FOUND

Found a 2 in. brass cap on 1 in. pipe in rock mound. Stamped "General Land Office; 1932".

2

DESCRIBE BEARING TREES OR OTHER OFFICIAL ACCESSORIES FOUND

Found 4 BT all dead.

- 1) 34 in Pine, healed scribed; T6N R 38E 35136 PLS 1636, 3/81
- 2) 8" snag, 54-3 sign S-E 58 lks. T6N R38 E, Sec. 35 RJ6/88
- 3) 12" scribed snag, 54-3 sign, 41½ lks. T6N R38E Sec. 36 RJ 6/88
- 4) 24" stump scribed, T6N,R38E Corn 35136 PLS 1636 3/81

6

PHOTO IDENTIFICATION DATA

Photo No. _____

Filed At. _____

Object Ident. _____

Ident. By _____

Signature _____ 7

PLANE COORDINATE POSITION DATA

State _____ Zone _____

X _____

Y _____

Estab. By _____

Agency _____ 8

DESCRIBE CORNER LOCATION RELATIVE TO NEAR-BY FEATURES, ALSO HOW TO REACH CORNER

Travel 1 mile east from intersection of F.S. Roads 65 and 6511 to abandoned dirt road. Follow west ½ mile, corner is on ridge in open.

3

Signature

Title

Division

Headquarters

Date

FS-7100-52 (3/68)

4

5

CORNER RECORD (PERPETUATION)

MONUMENT: DESCRIBE NEW MONUMENT SET, OR WORK DONE TO PRESERVE EXISTING MONUMENT

ACCESSORIES : DESCRIBE NEW BT'S WITNESS OBJECTS ETC. ESTABLISHED, OR WORK DONE TO PRESERVE EXISTING EVIDENCE

- 1) Scribed a 20' Spruce T6N R38E section 36 BT. Painted and placed appropriate signs. Bears N3 46'E 55.76' from corner.
- 2) Scribed in 15" Fir T6N R38E S 36 BT. Painted and placed appropriate sign bears N50 43' E 58.72' from corner.

Work Done By P. Tomkins Title PLS Date 7/92 State Registration No. OR 2360
or Agency

Certified Cor. Record Prepared ? (Yes) No Filed At: _____ Date _____

REMARKS

Index File No. Z 21 T. 6N R. 38E M. W.M. Tract or Surv. No. _____ Cor. _____

USDA-FOREST SERVICE

Index
File No. Z - 21

CORNER RECORD (SEARCH)

(Ref. FSM 7151.4)

Tract or
Survey No. _____
Cor.
No. _____

T 6N R. 38E R.D. WALLA WALLA County UMATILLA

Merid. WILLAMETTE N.F. UMATILLA State OREGON

CORNER DIAGRAM

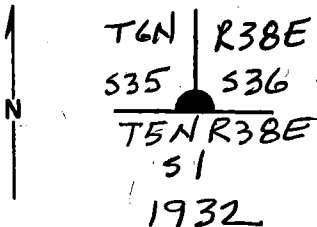

DESCRIBE CORNER MONUMENT FOUND

BRASS CAPPED IRON PIPE FOUND BY BLM

DESCRIBE BEARING TREES OR OTHER OFFICIAL ACCESSORIES FOUND

DESCRIBE CORNER LOCATION RELATIVE TO NEAR-BY FEATURES, ALSO HOW TO REACH CORNER

ON INDIAN RIDGE.

PHOTO IDENTIFICATION DATA

Photo No. _____

Filed At. _____

Object Ident. _____

Ident. By _____

Signature

PLANE COORDINATE POSITION DATA

State _____ Zone _____

X _____

Y _____

Estab. By _____

Agency

Signature

Title

Division

Headquarters

Date

FS-7100-52 (3/68)

1990

CORNER RECORD (PERPETUATION)

MONUMENT: DESCRIBE NEW MONUMENT SET, OR WORK DONE TO PRESERVE EXISTING MONUMENT

9

ACCESSORIES : DESCRIBE NEW BT's WITNESS OBJECTS ETC. ESTABLISHED, OR WORK DONE TO PRESERVE EXISTING EVIDENCE

10

Work Done By _____ Title _____ Date _____ State Registration No. or Agency _____

Certified Cor. Record Prepared ? Yes No Filed At: _____ Date _____

11

REMARKS

12

Index File No. T. R. M. Tract or Sury. No. Cor. 13

USDA-FOREST SERVICE

Index File No. Z-21

CORNER RECORD (SEARCH)

(Ref. FSM 7151.4)

Tract or Survey No. _____ Cor. No. _____

T 6N R. 38E

R.D. WALLAWALLA County UMATILLA

Merid. WILL

N.F. UMATILLA State OREGON

CORNER DIAGRAM

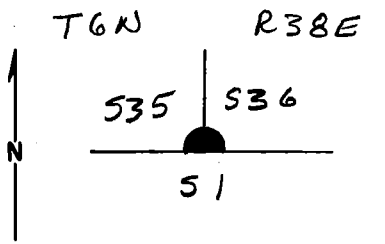

DESCRIBE CORNER MONUMENT FOUND

G.L.D. Brass Capped Iron pipe in M.O.S. Properly stamped & set in 1932

DESCRIBE BEARING TREES OR OTHER OFFICIAL ACCESSORIES FOUND

Shattered fir stump w/ scribing visible bears N 42 1/2 ° E, 72' ±

LARGE (36" ±) FIR SNAG B.T. NOT OF RECORD w/ SINGLE HEALED BLAZE BEARS S 50° W, 125 ft ±. SNOW PACK PREVENTED SEARCH FOR DOWN B.T.'S

PHOTO IDENTIFICATION DATA

Photo No. _____
Filed At. _____
Object Ident. _____
Ident. By _____
Signature _____

DESCRIBE CORNER LOCATION RELATIVE TO NEAR-BY FEATURES, ALSO HOW TO REACH CORNER

Brass Cap is on ridge top in opening.

PLANE COORDINATE POSITION DATA

State _____ Zone _____
X _____
Y _____
Estab. By _____
Agency _____

Signature Dennis J. Gaylord

Title PLS 1636

Headquarters _____

Date 3-18-81

7100-52 (3-68)

CORNER RECORD (PERPETUATION)

MONUMENT : DESCRIBE NEW MONUMENT SET, OR WORK DONE TO PRESERVE EXISTING MONUMENT

ACCESSORIES : DESCRIBE NEW BT'S WITNESS OBJECTS ETC. ESTABLISHED, OR WORK DONE TO PRESERVE EXISTING EVIDENCE

Work Done By _____ Title _____ Date _____ State Registration No. _____
or Agency _____
Certified Cor. Record Prepared ? Yes No Filed At: _____ Date _____

REMARKS

Index File No. T. R. M. Tract or Surv. No. Cor.

Index
File No. Z-21
T 6 N R. 38 E
Merid. WM

CORNER RECORD (SEARCH)

(Ref. FSM 7151.4)

Tract or
Survey No. _____

Cor.
No. 16 Sec. _____

R.D. Walla Walla County Umatilla
N.F. Umatilla State Oregon

CORNER DIAGRAM

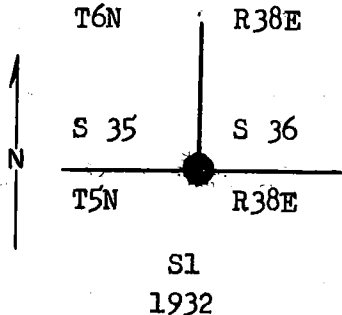

DESCRIBE CORNER MONUMENT FOUND

2" Iron pipe, 24" above ground.

DESCRIBE BEARING TREES OR OTHER OFFICIAL ACCESSORIES FOUND

A 30" fir, S 80° W, 115' Dist., blazed but could not read the markings.

A 20" fir, N30° W, 62' dist., marked T6N, R38E, Sec. 36 at the edge of the Indian Ridge Trail approx. 1/4 Mi. from road N-62.

(SEE BACK OF CARD)

DESCRIBE CORNER LOCATION RELATIVE TO NEAR-BY FEATURES, ALSO HOW TO REACH CORNER

PHOTO IDENTIFICATION DATA

Photo No. _____
Filed At. _____
Object Ident. _____
Ident. By _____
Signature

PLANE COORDINATE POSITION DATA

State _____ Zone _____
X _____
Y _____
Estab. By _____
Agency

Signature
D. B. Baker

Title
Eng. Tech.

Division
Engr.

Headquarters
Walla Walla

Date
9-3-63

7100-52 (3/68)

CORNER RECORD (PERPETUATION)

MONUMENT: DESCRIBE NEW MONUMENT SET, OR WORK DONE TO PRESERVE EXISTING MONUMENT

ACCESSORIES: DESCRIBE NEW BT'S WITNESS OBJECTS ETC. ESTABLISHED, OR WORK DONE TO PRESERVE EXISTING EVIDENCE

Work Done By _____	Title _____	Date _____	State Registration No. or Agency _____	10
Certified Cor. Record Prepared ?	Yes	No	Filed At: _____	Date _____

REMARKS

THE DESCRIPTIONS OF THE BEARING TREES GIVEN BY D. B. BAKER DIFFER WITH ~~DATA~~ THOSE GIVEN IN THE G.L.O. NOTES OF THE 1932 SURVEY. THE B.T.'S DESCRIBED IN THE 1932 SURVEY ARE: A FIR, 10" DIA., BEARS N 42 1/2° E., 110 LKS. (72.6 FT.) DIST, MKD. T6N R38E S36 B.T. A FIR, 10" DIA., BEARS N 81° W, 115 LKS. (75.9 FT.) DIST, MKD. T6N R38E S35-B.T. — THE BRASS CAP SHOULD BE STAMPED AS SHOWN IN THE CORNER DIAGRAM.

4-13-72 J.W. Blom

Index File No. Z-21	T.	R.	M.	Tract or Surv. No.	Cor.	12
---------------------	----	----	----	--------------------	------	----