

HISTORY OF ORIGINAL CORNER ESTABLISHMENT:

This record has been prepared to provide current information regarding the condition of the corner monument and accessories as described in the survey records cited below. Verification of the position of the corner monument and dimensions to existing accessories, and the establishment of new corner accessories was not performed as part of this visit.

The source of the monumentation and dimensions cited in this record is a Dependent Resurvey of ...Portions of the South and East Boundary, and Subdivisional Lines of Township 6 North, Range 38 East, Willamette Meridian, conducted by the Bureau of Land Management, commenced on October 13, 1987, and completed September 16, 1991.

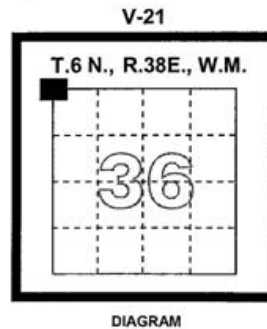

RECORD DESCRIPTION OF CORNER MONUMENT AND ACCESSORIES:

From the BLM Dependent Resurvey:

Point for the cor. of sec. 25, 26, 35 and 36, at proportionate distance, there is no remaining evidence of the original corner. Set a stainless steel post, 28 ins. long, 2 1/2 ins. diam., 24 ins. in the ground, in collar of stone, with brass cap mkd. (See diagram below), from which:

- A fir, 10 ins. diam., bears N 27 1/2°E 15 1/2 lks. dist., mkd. T6N R38E S25 BT,
- A fir, 17 ins. diam., bears S30 1/2°E 47 1/2 lks. dist., mkd. T6N R38E S36 BT,
- A fir 21 ins. diam., bears S 17 1/4°W 22 1/2 lks. dist., mkd. T6N R38E S35 BT,
- A fir, 14 ins. diam., bears N52 1/4°W 10 lks. dist., mkd. T6N R38E S26 BT,

Deposit a white "DEEP-1" magnetic marker at base of stainless steel post. The corner is located on NE slope.

DESCRIPTION OF MONUMENT AND ACCESSORIES FOUND AT THIS CORNER LOCATION:

Found:

A 3" dia. Brass cap, marked as shown, on a 2 1/2" dia. Stainless steel pipe, extending 6" above ground and in a small rock mound, on a steep NE slope, from which:

A 10" Grand Fir, alive and in good condition, with unreadable scribing visible on a partially healed blaze (BLM 1991 NE bearing tree),

A 16" Grand Fir, alive and in good condition, with scribing "T6N R38E S36 BT" visible on a partially healed single blaze (BLM 1991 SE bearing tree),

A 22" Douglas Fir, alive and in good condition, with a healed single blaze (BLM 1991 SW bearing tree),

A 14" Grand Fir, alive and in good condition, with illegible scribing visible on a partially healed blaze (BLM 1991 NW bearing tree)

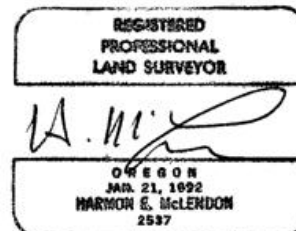
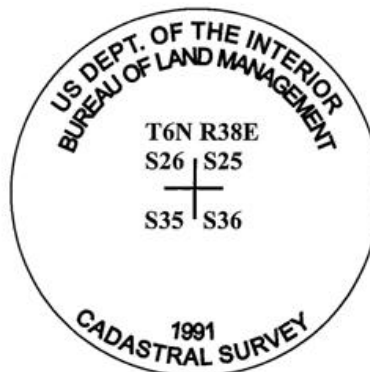

I hereby certify that the above corner position was visited and found as described on October 19, 2005.

Witnesses: Tim Johnson, Gary Langlitz, Jeremy Jones

RECEIVED BY

Walla Walla County Surveyor

Date 1-06

Rec'd by KK

No. 06-09-R