

OREGON CORNER RESTORATION FORM

COUNTY: Umatilla DATE: 04/29/09

CORNER DESIGNATION: V-11, The South One-Quarter Corner of Section 28, Township 6 North, Range 33 East, W.M.

PREVIOUS RENEWALS/SURVEYS ETC.: Corner originally established by Walden under GLO Contract No. 209, dated July 6, 1874. Notes state: Set basalt stone, 14 x 10 x 9, 7 ins. in ground, for 1/4 Sec. Cor.. The corner was recovered by Geary Kimbrell in 1906, under Survey No. 239, in 1906, when he established the Center 1/4 corner of Section 28.

MONUMENT AND ACCESSORIES FOUND: Found original 14 by 10 by 9 inch basalt stone, marked "1/4". Stone has been displaced by fence building/rock jack construction. Held East-West fence line for latitude and projected existing fence alignment South 01°47'32" East from the C-S 1/16th to determine departure for the corner.

MONUMENT MARKING DETAIL:

T6N R33E
1 S28
4 S33
2009
PLS 1106

MONUMENT SET: At reestablished corner point, set a 2 3/8" diameter brass cap on a 1 1/4 x 30" galvanized iron pipe, 24" in the ground with a earth and rock mound, marked as shown in "Monument Marking Detail". Deposit original stone on North side of monument.

New accessories:

A painted boulder, 27" x 20" x 18", marked "X BO" on South face, bears North 74° East, a distance of 85.2 feet.

A pink Deep-1 magnet bears South 42° East, a distance of 20.2 feet, buried 12 inches.

A 1 1/4" red plastic cap marked "OR PLS 1106, WA PLS 17372", on a 5/8" by 30" rebar, bears South 41° West, a distance of 15.5 feet.

A 1 1/4 red plastic cap marked "OR PLS 1106, WA PLS 17372", on a 5/8" x 30" rebar, bears North 49° West, a distance of 19.8 feet. Rebar driven 20 inches in the ground.

Set a steel fence post 3 feet North of corner with witness sign.

LOCATION AND COMMENTS: Corner is located in a old east-west fence line.

OREGON STATE PLANE COORDINATE, North Zone, NAD 83(91), International Feet:

N = 842883.02
E = 8661380.10

FIRM: Wells Surveying
P.O. Box 1696
Pendleton, OR 97801

COMPASS DECLINATION: 18° East

Surveyor's Seal

Witnesses: Matt Brockamp
D. Palmer

\6N33V11

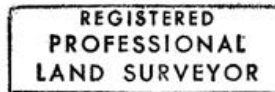

William R. Wells
OREGON
JULY 22, 1977
WILLIAM R. WELLS
1106

renews 6-30-10

09-87-B