

Index

File No. N-3

CORNER RECORD (SEARCH)

(Ref. FSM 7151.4)

Tract or Survey No. _____

Cor. No. 1/4

T 5B R. 33E

R.D. Ukiah

County Umatilla

Merid. Willamette

N.F. Umatilla

State Oregon

CORNER DIAGRAM

DESCRIBE CORNER MONUMENT FOUND

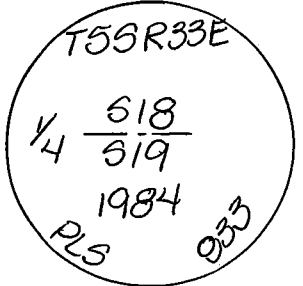

None

DESCRIBE BEARING TREES OR OTHER OFFICIAL ACCESSORIES FOUND

Found the SW BT which is now a 24" dia. weathered stump with fragmentary scribing visible. From the corner location as established from the SW BT An 18" badley weathered stump matches the GLO bearing and distance. Both stumps have signs #54-3 CORNER set from these stumps.

PHOTO IDENTIFICATION DATA

Photo No. _____
Filed At. _____
Object Ident. _____
Ident. By _____
Signature

DESCRIBE CORNER LOCATION RELATIVE TO NEAR-BY FEATURES, ALSO HOW TO REACH CORNER

From Hideway Springs, go West 1.5 mi, corner is South 0.6 mi across country

PLANE COORDINATE POSITION DATA

State _____ Zone _____
X _____
Y _____
Estab. By _____
Agency

Signature
David H. Klein

Title
PLS 933

Division

Headquarters

Date
7/16/84

7100-52-(3-68)

CORNER RECORD (PERPETUATION)

MONUMENT: DESCRIBE NEW MONUMENT SET, OR WORK DONE TO PRESERVE EXISTING MONUMENT

Set a 2 1/2" dia. Brass Cap on a 2 1/2" x 30" galvanized pipe 16" in the ground

Built a stone mound around the Brass Cap

ACCESSORIES : DESCRIBE NEW BT'S WITNESS OBJECTS ETC. ESTABLISHED, OR WORK DONE TO PRESERVE EXISTING EVIDENCE

A 7" dia. Ponderosa Pine bears N 25° W, 101.00 feet

A 7" dia. Ponderosa Pine bears S 46° E, 32.00 feet

Trees have signs #54-3 & 54-4 and Brass Washers

Work Done By R Panches Title Party Chief Date 7/29/84 State Registration No. _____ or Agency _____

Certified Cor. Record Prepared? Yes No Filed At: Unionville County Surveyor Date 7-24-84

REMARKS

Index
File No. N-3

CORNER RECORD (SEARCH)

(Ref. FSM 7151.4)

Tract or
Survey No. _____
Cor. No. N-3

T 5S R. 33E

R.D. UKiah County Umatilla

Merid. Wil.

N.F. Umatilla State Oregon

CORNER DIAGRAM

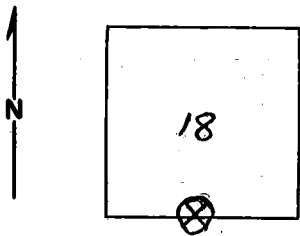

DESCRIBE CORNER MONUMENT FOUND

None. There are 2 rock Jacks in the nearby fence, and remnants of 2 or 3 older Jacks. Corner stone and mound probably is in one of these.

DESCRIBE BEARING TREES OR OTHER OFFICIAL ACCESSORIES FOUND

There is a Pine Stump, Approx. Call Size, with old upper and lower blazes on NE side. There is a remnant of scribing on the North edge of Lower blaze. Looks like top of the letter "7". Scars have been charred by fire.

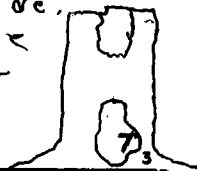

PHOTO IDENTIFICATION DATA

Photo No. _____
Filed At. _____
Object Ident. _____
Ident. By _____

PLANE COORDINATE POSITION DATA

State _____ Zone _____
X _____
Y _____
Estab. By _____
Agency _____

DESCRIBE CORNER LOCATION RELATIVE TO NEAR-BY FEATURES, ALSO HOW TO REACH CORNER

There is a Pine Stump, Approx. Call size, in the proper location for the NE B.T. It is badly weathered and no marks remain. Intersection of bearings and distances from these 2 stumps would place the 1/4 corner location about 12 ft. S20°E, from center of rock Jack in fence corner. Fences run north and east.

Signature

Tom Hollamer

Title

Division

Headquarters

Date

4-3-80

7100-52-(3/68)

CORNER RECORD (PERPETUATION)

MONUMENT: DESCRIBE NEW MONUMENT SET, OR WORK DONE TO PRESERVE EXISTING MONUMENT

9

ACCESSORIES : DESCRIBE NEW BT'S WITNESS OBJECTS ETC. ESTABLISHED, OR WORK DONE TO PRESERVE EXISTING EVIDENCE

I Placed a Blank B.T. Tag and an attention poster on each stump.

10

Work Done By _____ Title _____ Date _____ State Registration No. or Agency _____

Certified Cor. Record Prepared ? Yes No Filed At: _____ Date _____ 11

REMARKS
I feel sure these are the B.T.'s. Although the marks on the SW stump are minimal I feel sure they are scribe marks. Also the locations of the stumps conform to each other, the marks on the SW stump face the assumed corner location, and each would have been the nearest available tree, from the assumed corner location, North and South respectively of the section line.

12

Index File No. T. R. M. Tract or Surv. No. Cor. 13
N-3 SS 336 U.S. G.P.O. 1977-725-576/588

USDA-FOREST SERVICE

Index
File No. N-3

CORNER RECORD (SEARCH)
(Ref. FSM 7151.4)

Tract or
Survey No. _____ Cor.
No. N-3

T 5S R. 33E

R.D. Ukiah County Umatilla

Merid. Willamette

N.F. Umatilla State Oregon

CORNER DIAGRAM

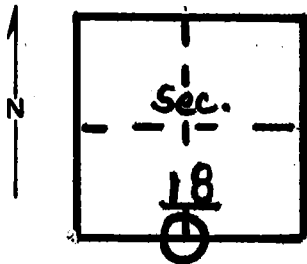

DESCRIBE CORNER MONUMENT FOUND

Material: None

DESCRIBE BEARING TREES OR OTHER OFFICIAL ACCESSORIES FOUND

East and north fence in general area. Logging has probably destroyed any evidence of 1/4 corner

PHOTO IDENTIFICATION DATA

Photo No. _____
Filed At. _____
Object Ident. _____
Ident. By _____
Signature

DESCRIBE CORNER LOCATION RELATIVE TO NEAR-BY FEATURES, ALSO HOW TO REACH CORNER

PLANE COORDINATE POSITION DATA

State _____ Zone _____
X _____
Y _____
Estab. By _____
Agency

Signature
Bill Moore

Title
Eng. Tech

Division _____

Headquarters _____

Date
5/77

7100-52-(3/68)

CORNER RECORD (PERPETUATION)

GPO 902-673

MONUMENT: DESCRIBE NEW MONUMENT SET, OR WORK DONE TO PRESERVE EXISTING MONUMENT

9

ACCESSORIES : DESCRIBE NEW BT'S WITNESS OBJECTS ETC. ESTABLISHED, OR WORK DONE TO PRESERVE EXISTING EVIDENCE

10

Work Done By _____ Title _____ Date _____ State Registration No.
or Agency _____

Certified Cor. Record Prepared ? Yes No Filed At: _____ Date _____ 11

REMARKS

12

Index File No. T. R. M. Tract or Surv. No. Cor. 13