

Index File No. E-9
 T 5 S. R. 30 E.
 Merid. Willamette

CORNER RECORD (SEARCH)
 (Ref. FSM 7151.4)

Tract or Survey No. _____
 Cor. No. _____

R.D. Ukiah County Umatilla
 N.F. Umatilla State Oregon

CORNER DIAGRAM

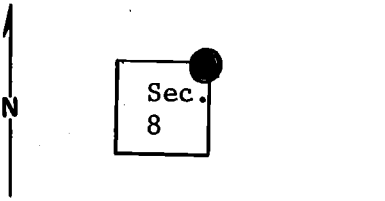

DESCRIBE CORNER MONUMENT FOUND

Basalt stone, 13"x8"x8", 8" above ground, fair condition.
 Fits GLO. Cannot distinguish marks.
 Stone located about 20 ft. south of small stream, under edge of old log.
Monumented By BLM in 1978

DESCRIBE BEARING TREES OR OTHER OFFICIAL ACCESSORIES FOUND

The original B.T.'s in Sec. 4, 8 and 9 are still standing and alive. The blazes had healed but have been chopped out and scribing is visible on all three. B.T. in Sec. 8 has old location poster. B.T. in Section 5 is now dead snag, scribing healed over.

PHOTO IDENTIFICATION DATA

Photo No. _____
 Filed At. _____
 Object Ident. _____
 Ident. By _____
Signature

DESCRIBE CORNER LOCATION RELATIVE TO NEAR-BY FEATURES, ALSO HOW TO REACH CORNER

Corner location is about 200 ft. south of Gravelled logging road (pit-run gravel).

PLANE COORDINATE POSITION DATA

State _____ Zone _____
 X _____
 Y _____
 Estab. By _____
Agency

Signature
 T, Hollamon

Title
 Eng. Tech,

Division

Headquarters
 S,O,

Date
 5/1/74

7100-52-(3/68)

CORNER RECORD (PERPETUATION)

MONUMENT: DESCRIBE NEW MONUMENT SET, OR WORK DONE TO PRESERVE EXISTING MONUMENT

ACCESSORIES : DESCRIBE NEW BT's WITNESS OBJECTS ETC. ESTABLISHED, OR WORK DONE TO PRESERVE EXISTING EVIDENCE

I placed blank B.T. tags on all four B.T.'s; also placed a location poster on 7" p. pine in north edge of road approx. 200 ft. north of corner.

Work Done By _____ Title _____ Date _____ State Registration No. or Agency _____

Certified Cor. Record Prepared ? Yes No Filed At: _____ Date _____

REMARKS

Index File No. T. R. M. Tract or Surv. No. Cor.