

Index  
File No. N-23

**CORNER RECORD (SEARCH)**  
(Ref. FSM 7151.4)

Tract or  
Survey No. \_\_\_\_\_ Cor.  
No. \_\_\_\_\_

T 5S R. 29E

R.D. Ukiah County \_\_\_\_\_

Merid. W.M.

N.F. Umatilla State Oregon

**CORNER DIAGRAM**

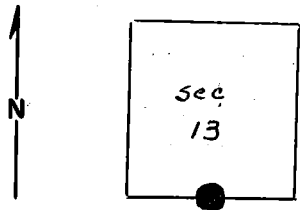

**DESCRIBE CORNER MONUMENT FOUND**

Stone found 17x15x3 marked 1/4, very good. All above ground. Condition is good.

*Monumented by BLM, 1978*

**DESCRIBE BEARING TREES OR OTHER OFFICIAL ACCESSORIES FOUND**

Stone painted red and put a steel post about 3' from stone with two attention signs to it. A ponderosa pine bearing S 11° W from stone, 21" in DBH 72 lks, painted with 6" band and painted scars, is in good condition. A ponderosa pine bearing S 5° E 76 lks, painted 6" red band and painted scars, is also in good condition. Both these trees have proper tags nailed to them.

**DESCRIBE CORNER LOCATION RELATIVE TO NEAR-BY FEATURES, ALSO HOW TO REACH CORNER**

**PHOTO IDENTIFICATION DATA**

Photo No. \_\_\_\_\_  
Filed At. \_\_\_\_\_  
Object Ident. \_\_\_\_\_  
Ident. By \_\_\_\_\_  
*Signature*

**PLANE COORDINATE POSITION DATA**

State \_\_\_\_\_ Zone \_\_\_\_\_  
X \_\_\_\_\_  
Y \_\_\_\_\_  
Estob. By \_\_\_\_\_  
*Agency*

Signature  
M.L. Christian

Title  
F.T.

Division

Headquarters

Date

7100-52-(3/68)

**CORNER RECORD (PERPETUATION)**

**MONUMENT: DESCRIBE NEW MONUMENT SET, OR WORK DONE TO PRESERVE EXISTING MONUMENT**

9

**ACCESSORIES : DESCRIBE NEW BT'S WITNESS OBJECTS ETC. ESTABLISHED, OR WORK DONE TO PRESERVE EXISTING EVIDENCE**

10

Work Done By \_\_\_\_\_ Title \_\_\_\_\_ Date \_\_\_\_\_ State Registration No. \_\_\_\_\_  
or Agency \_\_\_\_\_

Certified Cor. Record Prepared ? Yes No Filed At: \_\_\_\_\_ Date \_\_\_\_\_ 11

**REMARKS**

12

Index File No. \_\_\_\_\_ T. \_\_\_\_\_ R. \_\_\_\_\_ M. \_\_\_\_\_ Tract or Surv. No. \_\_\_\_\_ Cor. \_\_\_\_\_ 13