

USDA-FOREST SERVICE

Index

File No. L-9

CORNER RECORD (SEARCH)

N.L. Fk. (Ref. FSM 7151.4)

Tract or

Cor.

T 4S R. 33E

R.D. John Day

County Umatilla

Survey No. _____

No. _____

Merid. W.M.

N.F. Umatilla

State Or.

CORNER DIAGRAM

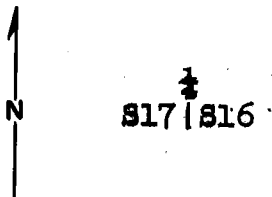

DESCRIBE CORNER MONUMENT FOUND

2 1/2" iron pipe with brass cap mkd.:
in a stone mound.

T4S R33E

1/4
S17|S16
1977

DESCRIBE BEARING TREES OR OTHER OFFICIAL ACCESSORIES FOUND

P. Pine, 17", N74°E, 92.4', with healed blaze.
P. Pine, 26", S70°W, 41.6', with scribing visible.

PHOTO IDENTIFICATION DATA

Photo No. _____

Filed At. _____

Object Ident. _____

Ident. By _____

Signature

PLANE COORDINATE POSITION DATA

State _____ Zone _____

X _____

Y _____

Estab. By _____

Agency

Signature

F. J. Munro

Title

Division

Headquarters

Date

4/28/87

FS-7100-52 (3/68)

CORNER RECORD (PERPETUATION)

MONUMENT: DESCRIBE NEW MONUMENT SET, OR WORK DONE TO PRESERVE EXISTING MONUMENT

ACCESSORIES : DESCRIBE NEW BT'S WITNESS OBJECTS ETC. ESTABLISHED, OR WORK DONE TO PRESERVE EXISTING EVIDENCE

BTs have blaze and 6" band painted red, BT tags and "Attention" signs. There is a 6' steel fence post with an "Attention" sign within 5' of the corner.

Work Done By. F.S. Munro Title PLS Date 4/26/87 State Registration No. 1832
or Agency
Certified Cor. Record Prepared ? Yes No Filed At: _____ Date _____

REMARKS

Index File No. L-9 T. 48 R. 33E M. W.M. Tract or Surv. No. _____ Cor. _____