

Index

File No. R-13

CORNER RECORD (SEARCH)

(Ref. FSM 7151.4)

Tract or
Survey No. _____Cor.
No. _____T 4S R. 31ER.D. UkiahCounty UmatillaMerid. WillametteN.F. UmatillaState Oregon

CORNER DIAGRAM

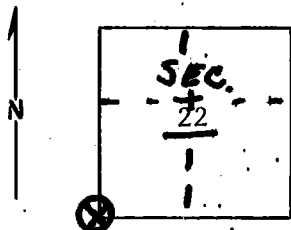

DESCRIBE CORNER MONUMENT FOUND

Stone Mound

None visible. Mound appears to be in approx. proper location, but there are no accessories to prove it.

DESCRIBE BEARING TREES OR OTHER OFFICIAL ACCESSORIES FOUND

None. There is a pine stump which appears to be in approx. proper location. It shows a pitch seam at about the proper ring count. I opened stump with saw but found no scribing. If it was a BT it has been cut below the scribing.

PHOTO IDENTIFICATION DATA

Photo No. _____

Filed At. _____

Object Ident. _____

Ident. By _____

Signature

PLANE COORDINATE POSITION DATA

State _____ Zone _____

X _____

Y _____

Estab. By _____

Agency

Signature

Title

Division

Headquarters

Date

7100-52-(3/68)

TOM HOLLAMON

ENG. TECH.

5/5/78

CORNER RECORD (PERPETUATION)

GPO 902-673

MONUMENT: DESCRIBE NEW MONUMENT SET, OR WORK DONE TO PRESERVE EXISTING MONUMENT

9

ACCESSORIES : DESCRIBE NEW BT'S WITNESS OBJECTS ETC. ESTABLISHED, OR WORK DONE TO PRESERVE EXISTING EVIDENCE

10

Work Done By _____ Title _____ Date _____ State Registration No. or Agency _____

Certified Cor. Record Prepared ? Yes No Filed At: _____ Date _____

11

REMARKS

Bearings from a corner north and a corner east indicate that this is the corner, also a local resident told me that surveyor Ralph Thompson monumented a corner on the line north by using this mound for control. He must have used it since there is no other evidence south of here nor along the Township line on south side of Township.

12

Index File No. T. R. M. Tract or Surv. No. Cor.

13