

Form 874-9—Revised November 1939
 U. S. Department of Agriculture
 FOREST SERVICE

Umatilla

NATIONAL FOREST

CORNERS OF THE PUBLIC SURVEY

T. 45 R. 31 E Will Mer.

1/4 Corner common to Sections
5, 8, -, and -

Corner consists of a Stone Mound in place
 State condition Fair

Dimensions above ground 30" diam. 6" high inches.

Sketch grooves, letters, figures, or notches, on proper face or edge.

CARDINAL POSITION				DIAGONAL POSITION			
		<u>N</u>	<u>o</u>	<u>n</u>	<u>e</u>		
		N	W	S	E	NW	SW
						SE	NE

Mound of _____ is located _____

Pits are located _____

Sketch markings of Bearing Trees (or Rocks) in proper box and fill blanks below, giving bearings from Corner to Trees and Distances in Links.

<u>1/4 S</u>	<u>1/4 S</u>		
<u>Grown over</u>	<u>over</u>		

Species PP DF
 Diameter 24" 18"
 Bearing S.03°E N04°E
 Distance 49' 6'

Do you believe this to be a genuine Land Office Corner? Yes
 If not, why? _____

A J Warren
 (Signature)

For Awd TM
 (Title)

8/11/53
 (Date)

T. _____ R. _____ Mer. _____
 (Make sketch of topography near Corner and show section line markers thus "X")

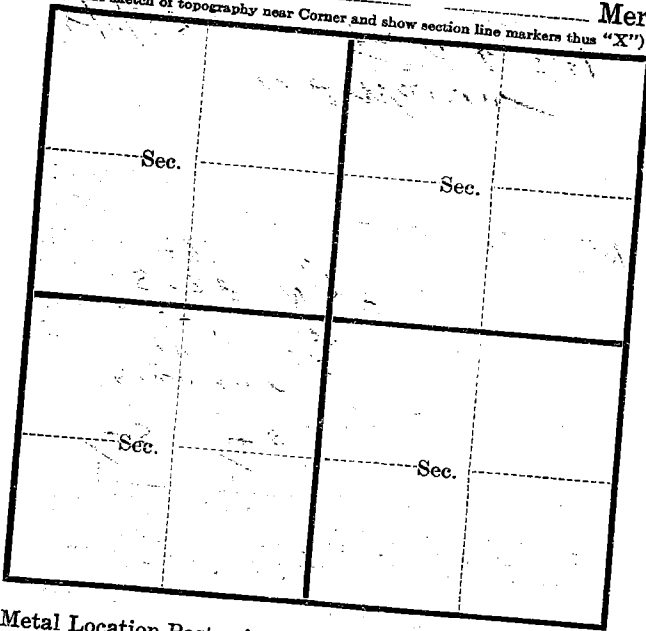

Metal Location Poster is on a _____
 tree _____ inches diameter, on the _____
 side of _____ from which
 this Corner bears _____ (Bearing) _____ (Distance) Chains.
 Section line marker between Secs. _____ and _____ is on
 a _____ on the _____
 (Tree, post, etc.) (Name of road, trail, etc.)
 located _____ chains E, W, N, S, from Sec. Cor.; 1/4 Cor.; Witness Cor.
 (Cross out nonapplicable)
 Give any further facts needed to find Corner again:

Index File No. E-7
 T 4 S. 31 E.

CORNER RECORD (SEARCH)
 (Ref. FSM 7151.4)

Tract or Survey No. _____
 Cor. No. _____

Merid. Willamette

R.D. Ukiah County Umatilla
 N.F. Umatilla State Oregon

CORNER DIAGRAM

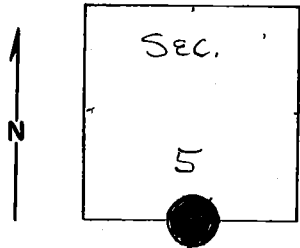

DESCRIBE CORNER MONUMENT FOUND

Monumented By
 Material: Basalt stone
 Size: 12"x8"x7"
 Height above Ground: 6"
 Condition: loose

BLM, 1978

Markings: none visible, in loose mound of stone 2'x2'

DESCRIBE BEARING TREES OR OTHER OFFICIAL ACCESSORIES FOUND

N 120E., 7' distance is 20" Douglas fir blazed on south face, scribed: 1/4. Forest Service location poster dated: 8/28/57. Above location poster is Attention poster (4/1909). South, approximately 50' distance is 28" ponderosa pine blazed on north face, scribed 1/4 with Forest Service Attention poster above blaze. Bearing tree north of corner is in east-west fence line (live but spike top). Corner is on east facing slope. 2"x2" sq. native stake (back)

DESCRIBE CORNER LOCATION RELATIVE TO NEAR-BY FEATURES, ALSO HOW TO REACH CORNER

PHOTO IDENTIFICATION DATA

Photo No. _____
 Filed At. _____
 Object Ident. _____
 Ident. By _____

Signature

PLANE COORDINATE POSITION DATA

State _____ Zone _____
 X _____
 Y _____
 Estab. By _____

Agency

Signature

Title Engr. Tech. Division _____ Headquarters _____

Date 4/76

7100-52-(3/68)

CORNER RECORD (PERPETUATION)

MONUMENT: DESCRIBE NEW MONUMENT SET, OR WORK DONE TO PRESERVE EXISTING MONUMENT

9

ACCESSORIES : DESCRIBE NEW BT's WITNESS OBJECTS ETC. ESTABLISHED, OR WORK DONE TO PRESERVE EXISTING EVIDENCE

Put up bearing tree posters on both BT's.

10

Work Done By _____ Title _____ Date _____ State Registration No. or Agency _____

Certified Cor. Record Prepared ? Yes No Filed At: _____ Date _____ 11

(3 cont'd) in mound of stone (not original stake). ^{REMARKS}

12

Index File No. T. R. M. Tract or Surv. No. Cor. 13