

CERTIFIED RECORD OF LAND CORNER MONUMENTATION

History of original corner establishment:

Corner not previously established.

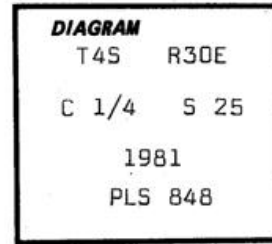

T-23

Description of corner evidence found:

N/A

Description of monument and accessories established to perpetuate the original location of this corner:

Set 3"x30" galv. iron pipe with 3" brass cap stamped as shown on the diagram; set 24 inches in the ground.

From which:

A pine 13 inches dia. bears N13°W, 19.4 ft. scribed C 1/4 S 25 BT.

A pine 14 inches dia. bears S27°E, 62.9 ft. scribed C 1/4 S 25 BT.

Set steel posts with warning and boundary signs 5 ft. West and 5 ft. North from corner.

Nailed bearing tree signs and brass washers stamped PLS 848 to each tree. Painted red band around each tree.

I hereby certify that the above corner monument was established as herein described on 8/13/81.

Witnesses:

D. Mitchell Ferguson

Mike Woodward

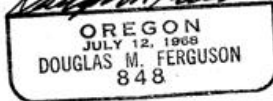
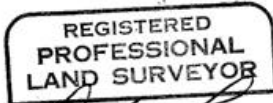

Office of... Co. Surveyor..... County of... Umatilla
 State of... Oregon....., I hereby certify that the within instrument was filed in this office
 for record on the... 7th day of... January....., 1982
 by... David Baumlein..... (COUNTY OFFICIAL) by... Betty Shatto..... (DEPUTY)

87-01-C

T-2