

CERTIFIED RECORD OF LAND CORNER MONUMENTATION

History of original corner establishment:

This corner was originally established by George S. Pershin under G.L.O. contract no. 430 dated March 23, 1882. He set a basalt stone 18"x8"x7", 12" in the ground and marked $\frac{1}{4}$ on the west side. No BTs were available; he raised a stone mound alongside the corner.

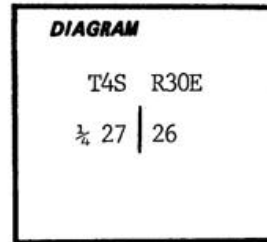

Description of corner evidence found:

Found a stone 18"x8"x7" marked $\frac{1}{4}$.

Description of monument and accessories established to perpetuate the original location of this corner:

In place of the original stone set a 2 $\frac{1}{2}$ "x30" alum. pipe with a 3" alum. cap containing a magnet and marked:

Buried the original stone alongside of and built a stone mound around the monument. Marked new BTs:
A P. pine, 10" dia., N55 $\frac{1}{2}$ °E, 92.5 ft marked: $\frac{1}{4}$ S26 BT
A P. pine, 13" dia., N22 3/4°W, 26.3 ft. marked: $\frac{1}{4}$ S27 BT

T4S R30E

$\frac{1}{4}$	
S27	S26
PLS	1832
1984	

BTs have blaze and a 6" stripe painted red, a BT tag, an "Attention" sign and an alum. "PLS 1832" washer nailed to the bottom of the blaze. There is a 6' steel fence post with an "Attention" sign within 5' of the corner.

Measured to center of BTs using steel tape and theodolite; bearings are true.

September 18, 1984.

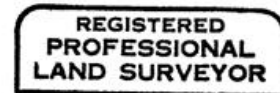

Fayette S. Munro



Office of Supervisor County of Umatilla
 State of Oregon, I hereby certify that the within instrument was filed in this office
 for record on the 10 day of October, 1984
David H. Krumboltz by _____
 (COUNTY OFFICIAL) (DEPUTY)