

Index  
File No. N-3

**CORNER RECORD (SEARCH)**

(Ref. FSM 7151.4)

Tract or  
Survey No. \_\_\_\_\_ No. \_\_\_\_\_

T 45 R. 30E

R.D. Ukiah County Umatilla

Merid. Willamette

N.F. Umatilla State Oregon

**CORNER DIAGRAM**



T45 R30E

1/4  $\frac{S\ 18}{S\ 19}$

1981

PLS 848

**DESCRIBE CORNER MONUMENT FOUND**

Found broken 11x10x7 in. stone with 1/4 clearly visible.

From which

**DESCRIBE BEARING TREES OR OTHER OFFICIAL ACCESSORIES FOUND**

Found pine 42 in. dia., dead, down and rotten, blaze and axe marks visible, bears approx. North 16 ft.  
Found pine 50 in. dia., dead, down and rotten, bears approx. S35°E, 38 ft. No marks visible.  
Accepted stone as 1/4 corner position.

**PHOTO IDENTIFICATION DATA**

Photo No. \_\_\_\_\_  
Filed At: \_\_\_\_\_  
Object Ident. \_\_\_\_\_  
Ident. By \_\_\_\_\_  
*Signature*

**DESCRIBE CORNER LOCATION RELATIVE TO NEAR-BY FEATURES, ALSO HOW TO REACH CORNER**

Corner is on level ground in pine and fir timber, approx. 10 ft. South of an E-W fence line. Fence can be followed from East or West to the corner.

**PLANE COORDINATE POSITION DATA**

State \_\_\_\_\_ Zone \_\_\_\_\_  
X \_\_\_\_\_  
Y \_\_\_\_\_  
Estab. By \_\_\_\_\_  
*Agency*

Title PLS 848 Division \_\_\_\_\_ Headquarters Mt. Vernon, OR Date 9/81  
7100-52-(3/68)

*Signature*

## CORNER RECORD (PERPETUATION)

## MONUMENT: DESCRIBE NEW MONUMENT SET, OR WORK DONE TO PRESERVE EXISTING MONUMENT

Set 3"x30" galv. iron pipe with 3" brass cap, stamped as shown on the diagram, set 16 inches in the ground and placed a ring of stone around the pipe.  
Placed original stone North alongside pipe.  
From which

## ACCESSORIES: DESCRIBE NEW BT'S WITNESS-OBJECTS ETC. ESTABLISHED, OR WORK DONE TO PRESERVE EXISTING EVIDENCE

A fir 15 in. dia. bears S3°E, 5.7 ft. scribed 1/4 S 19 BT.  
A fir 18 in. dia. bears N38°E, 10.5 ft. scribed 1/4 S 18 BT.  
Set steel posts with warning and boundary signs 5 ft. East and 5 ft. West from corner.  
Nailed bearing tree signs and brass washers stamped PLS 848 to each tree. Painted red band around each tree.

Work Done By D.M. Ferguson Title Surveyor Date 9/81 State Registration No. OR PLS 848  
or Agency

Certified Cor. Record Prepared? Yes  No  Filed At: Umatilla Co. Surveyor Off. Date

REGISTERED  
PROFESSIONAL  
LAND SURVEYOR

## REMARKS

Witnesses to above corner:

D. Mitchell Ferguson  
Mike Woodward

OREGON  
JULY 12, 1968  
DOUGLAS M. FERGUSON  
848

Index File No.

T.

R.

M.

Tract or Surv. No.

Cor.

USDA-FOREST SERVICE

Index  
File No. N-3

**CORNER RECORD (SEARCH)**

(Ref. FSM 7151.4)

Tract or Survey No. \_\_\_\_\_ Cor. No. \_\_\_\_\_

T 4S. R. 30E R.D. Ukiah County Umatilla

Merid. Willamette N.F. Umatilla State Oregon

**CORNER DIAGRAM**

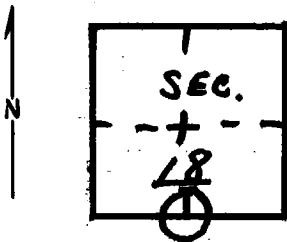

**DESCRIBE CORNER MONUMENT FOUND**

None.

**DESCRIBE BEARING TREES OR OTHER OFFICIAL ACCESSORIES FOUND**

East-west fence line and blaze line. Found large down tree with typical blaze fold. No scribing. Possible BT.

**PHOTO IDENTIFICATION DATA**

Photo No. \_\_\_\_\_

Filed At. \_\_\_\_\_

Object Ident. \_\_\_\_\_

Ident. By \_\_\_\_\_

*Signature*

**PLANE COORDINATE POSITION DATA**

State \_\_\_\_\_ Zone \_\_\_\_\_

X \_\_\_\_\_

Y \_\_\_\_\_

Estab. By \_\_\_\_\_

*Agency*

**DESCRIBE CORNER LOCATION RELATIVE TO NEAR-BY FEATURES, ALSO HOW TO REACH CORNER**

Signature  
Bill Moore

Title  
Eng. Tech.

Division

Headquarters

Date

4/78

7100-52-(3/68)

**CORNER RECORD (PERPETUATION)**

GPO 902-673

**MONUMENT: DESCRIBE NEW MONUMENT SET, OR WORK DONE TO PRESERVE EXISTING MONUMENT**

9

**ACCESSORIES : DESCRIBE NEW BT'S WITNESS OBJECTS ETC. ESTABLISHED, OR WORK DONE TO PRESERVE EXISTING EVIDENCE**

10

Work Done By \_\_\_\_\_ Title \_\_\_\_\_ Date \_\_\_\_\_ State Registration No. or Agency \_\_\_\_\_

Certified Cor. Record Prepared ? Yes No Filed At: \_\_\_\_\_ Date \_\_\_\_\_

11

**REMARKS**

12

Index File No. T. R. M. Tract or Surv. No. Cor. \_\_\_\_\_

13