

Form 874-9—Revised May, 1918

U. S. Department of Agriculture

FOREST SERVICE

Umatilla

NATIONAL FOREST

CORNERS OF THE PUBLIC SURVEY

T. 3-4 N. R. 37 E. W. Mer.

Section Corner common to Sections

1, 2, 35, and 36

Corner consists of a B.T. ~~(not)~~ in place

State condition not chopped out

Dimensions above ground _____ inches.

Sketch grooves, letters, figures, or notches, on proper face or edge.



N W S E

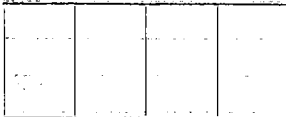

NW SW SE NE

Mound of _____ is located _____

_____ Pits are located _____

Sketch markings of Bearing Trees (or Rocks) in proper box and fill blanks below, giving bearings from Corner to Trees and Distances in Links.

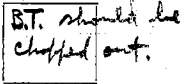

Species D.F.

Diameter approx 3 feet

Bearing N.E. of corner

Distance ?

Do you believe this to be a genuine Land Office Corner? Yes

If not, why? _____

Bernard Lee

(Signature)

7-2-31

(Date)

J. R. E.

(Title)

T. 3-4N R. 37E W. Mer.

(Make sketch of topography near Corner)

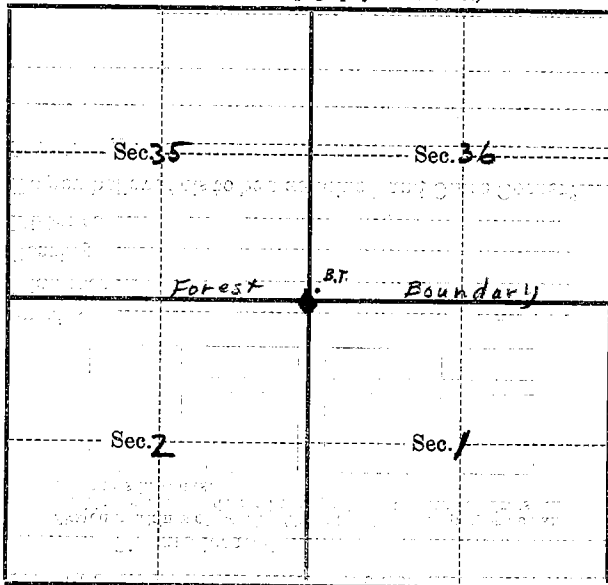

Metal Location Poster is on a none
tree _____ inches diameter, on the _____
side of _____
from which this Corner bears _____
_____ chains distant.

Give any further facts which will aid in finding this
Corner again.

Suspected B.T. approx. 7 chains
east of Forest Boundary sign above trail
south of Coyote Creek. Blazed region,
with knife near tree which has
small top and is a large fir
about 3 feet in diam. Also
needed to chop out tree. No other
B.T. found on rocks or stakes.
However, very certain that this is
B.T. which was found.

Index _____
 File No. A 21 **CORNER RECORD (SEARCH)** (Ref. FSM 7151.4) Tract or Survey No. _____ Cor. No. A 21
 T 3 N R. 37 E R.D. Pendleton County Umatilla
 Merid. Willamette N.F. Umatilla State Oregon

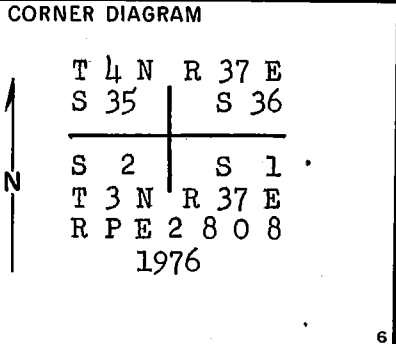

DESCRIBE CORNER MONUMENT FOUND

NONE

DESCRIBE BEARING TREES OR OTHER OFFICIAL ACCESSORIES FOUND

NONE

PHOTO IDENTIFICATION DATA

Photo No. _____
 Filed At. _____
 Object Ident. _____
 Ident. By _____
 Signature _____

7

DESCRIBE CORNER LOCATION RELATIVE TO NEAR-BY FEATURES, ALSO HOW TO REACH CORNER

Westerly from west edge of Tollgate 3.5 miles to road between metal snow fences- Thence southerly approx. 1.2 miles to road forks- Thence west 2000 feet from location tag on 4" fir marked 1/4 cor east 500 feet

PLANE COORDINATE POSITION DATA

State _____ Zone _____
 X _____
 Y _____
 Estab. By _____

8

Signature James D. Hankley Title _____ Division RPE 2808 Headquarters _____ Date 7/22/76 7100-52 (3/68)

CORNER RECORD (PERPETUATION)

MONUMENT: DESCRIBE NEW MONUMENT SET, OR WORK DONE TO PRESERVE EXISTING MONUMENT

Set a 2 $\frac{1}{2}$ " brass cap on a 2" iron pipe 31" long 6" above the ground with a 6" Steel fence post 3' north with sign 54-4 attached.

ACCESSORIES : DESCRIBE NEW BT'S WITNESS OBJECTS ETC. ESTABLISHED, OR WORK DONE TO PRESERVE EXISTING EVIDENCE

- A fir 12" diam. bears S 21° W., 51.0 ft. dist. marked T 3 N., R37 E S 2 BT
- A fir 15" diam. bears S 32° E., 105.0 ft. dist. marked T 3 N R 37 E S 1 BT
- A fir 12" diam. bears N 71° W., 60.0 ft. dist. marked T 4 N R 37 E S 35 BT
- A fir 12" diam. bears N 51° E., 110.0 ft. dist. marked T 4 N R 37 E S 36 BT

Each BT has a sign 54-3 attached 6" below a band of red paint and has a brass washer marked RPE 2808 nailed flush with BT blaze.

Work Done By James D. Hanley Title Engineer Date 7/27/76 State Registration No. ORPE 2808
or Agency

Certified Cor. Record Prepared ? Yes Filed At: Pendleton, Oregon Date 8/ /76

REMARKS

USDA-FOREST SERVICE

Index File No. Z-21

CORNER RECORD (SEARCH)

(Ref. FSM 7151.4)

Tract or Survey No. _____ No. _____

T 4N R. 37E

R.D. _____ County _____

Merid. _____

N.F. _____ State _____

CORNER DIAGRAM

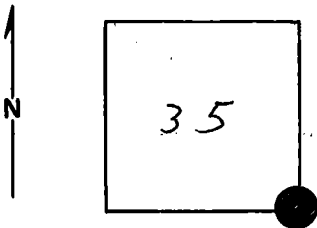

DESCRIBE CORNER MONUMENT FOUND

Brass Cap! 500 mm, F. 10 or (CR: T3N R37E A21)

DESCRIBE BEARING TREES OR OTHER OFFICIAL ACCESSORIES FOUND

PHOTO IDENTIFICATION DATA

Photo No. _____

Filed At. _____

Object Ident. _____

Ident. By _____

Signature

PLANE COORDINATE POSITION DATA

State _____ Zone _____

X _____

Y _____

Estab. By _____

Agency

Signature

Title

Division

Headquarters

Date

7100-52-(3/68)

CORNER RECORD (PERPETUATION)

MONUMENT: DESCRIBE NEW MONUMENT SET, OR WORK DONE TO PRESERVE EXISTING MONUMENT

9

ACCESSORIES : DESCRIBE NEW BT's WITNESS OBJECTS ETC. ESTABLISHED, OR WORK DONE TO PRESERVE EXISTING EVIDENCE

10

Work Done By. _____ Title _____ Date _____ State Registration No. or Agency _____

Certified Cor. Record Prepared ? Yes No Filed At: _____ Date _____

11

REMARKS

12

Index File No.

T.

R.

M.

Tract or Surv. No.

Cor.

13