

OREGON CORNER RESTORATION FORM

COUNTY: Umatilla DATE: 4/09/15

CORNER DESIGNATION: The North One-Quarter Corner of Section 1, Township 3 North, Range 31 East, A-23.

PREVIOUS RENEWALS/SURVEYS ETC.: Corner originally established by D.S. Payne, under Contract No. 100, dated 8/1/1861, notes state: Set charred stake with mound trench and pits as per instrs. for 1/4 sec corner.

MONUMENT AND ACCESSORIES FOUND: None.

MONUMENT MARKING DETAIL:

T4N R31E
1 S36
4 S1
T3N
2015
PLS 54657

MONUMENT SET:

Held intersection of field berms East-West and South as best remaining evidence of the original corner position and set a 2 3/8" brass cap on a 1 1/4" x 30" galvanized iron pipe, top flush with ground, stamped as shown in "Monument Marking Detail".

From which:

- A silver deep-1 magnet, 20" below ground level, bears North 33° East, 28.0 feet.
- A pink deep-1 magnet, 20" below ground level, bears South 30° East, 27.6 feet.
- An blue deep-1 magnet, 20" below ground level, bears South 39° West, 35.5 feet.
- An orange deep-1 magnet, 20" below ground level, bears North 49° West, 39.2 feet.

Buried bearing object tags with magnets. Set steel fence post 1 foot East of monument and set wood post 1.5 feet North of monument with witness sign attached.

LOCATION AND COMMENTS: At the intersection of field berms East, West and South.

OREGON STATE PLANE COORDINATE, North Zone, NAD 83(91), International Feet:

N = 773260.00
E = 8615200.30

FIRM: Wells Surveying
P.O. Box 1696
Pendleton, OR 97801

COMPASS DECLINATION: 18° East Surveyor's Seal

Witnesses: Jason Wells, PLS
Dean Roy

/3N31A23

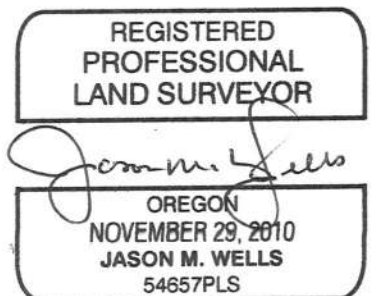

15-052-C

RENEWS: 6-30-16