

CORNER RESTORATION FORM

Township 4N Range 29E Section 30, 31 County UMATILLA

State OREGON Date 3/30/2023 Number V-3

Condition Report Only

Corner Designation : 1/4 CORNER: 30, 31

Not Found
 Renewed

Previous Renewals ORIGINAL SOURCE OF CORNER

Surveyed In
 Referenced

ORIGINALLY SURVEYED IN 1861 BY DAVENPORT UNDER

CONTRACT #101, HE SET A STAKE IN MOUND OF EARTH

MONUMENT DETAIL

Found Set

1973 KRUMBEIN SET BRASS CAP COUNTY SURVEY NO. I-021-C

1998 HADDOCK RESET A 1"X30" I.P. W/2 1/4" BRASS CAP

COUNTY SURVEY NO. 98-155-C & CORNER FORM NO.

V3-98-155-C

BASIS OF BEARINGS, NAD 83/91 OREGON STATE PLANE
COORDINATES NORTH ZONE:

NORTHING: 777141.24
EASTING: 8524519.10

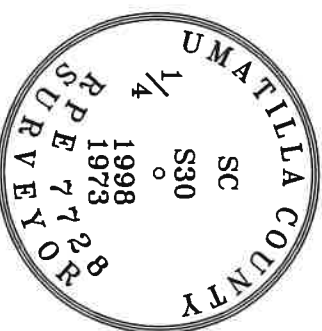

Monument & Accessories Set/Found (Procedure and Description)

AT CORNER FOUND A 2 1/4" BRASS CAP & SET A UMATILLA MON. SIGN, COUNTY SURVEY NO. 98-155-C & CORNER FORM NO. V3-98-155-C

FOUND A 1/2"X24" IRON ROD W/ALUMINUM CAP 951 W.C., 1' BELOW GRADE N 01°12' W 9.90', CORNER FORM

NO. V3-95-060-B

FOUND A 3/4"X27" IRON PIPE BENT SOUTHWEST TIED SPINHOLE N 88°48' E 10.11', CORNER FORM NO.

V3-95-060-B

FOUND A 5/8" IRON ROD W/YELLOW PLASTIC CAP "PLS LS 48509" 8" BELOW GRADE S 01°17' E 10.00',

CORNER FORM NO. V3-02-49-G

FOUND A 1 1/4"X34" IRON ROD 1" BELOW GRADE S 88°51' W 9.98', CORNER FORM NO. V3-95-060-B

Sketch of Monument, Accessories and General Area

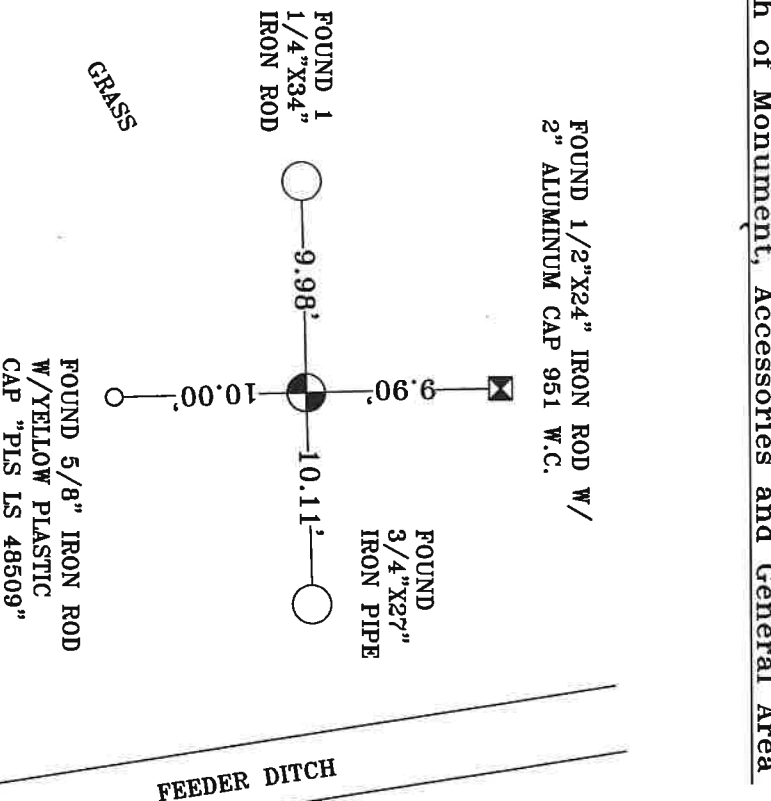

REGISTERED PROFESSIONAL LAND SURVEYOR

Lance Clark King
OREGON
 MAY 10, 2011
LANCE CLARK KING
 61420

RENEWALS: 6/30/2023

Agency: **CK3, LLC**
 945 W. ORCHARD
 HERMISTON OREGON 97838
 OFFICE: 541-567-2345
 FAX: 541-567-2305
 WEB: CK3LLC.NET
 Field Book# 0-350

COUNTY SURVEYOR RECORDING INFO

Received CT

Filed 5/4/23

Survey No. 23-042-C

Drawing No. _____

Index No. V-3