

OREGON CORNER RESTORATION FORM

SECTION 23 TOWNSHIP 4 NORTH RANGE 29 EAST N-21

COUNTY : UMATILLA DATE 11-2001

CORNER DESIGNATION

NE CORNER

- CONDITION REPORT ONLY
- NOT FOUND
- RENEWED
- UNCOVERED
- SURVEYED IN
- REFERENCED

PREVIOUS RENEWALS / SURVEYS, ETC.

ORIGINALLY SURVEYED IN 1861 BY DAVENPORT UNDER CONTRACT #101. HE SET A POST IN A MOUND OF EARTH AND A CHARRED STAKE. ALSO, TUTTLE FOUND 17"x12"x10" STONE IN 1991 SURVEY, COUNTY #91-109-B.
 IN 1998 I SET A 1"x30" IRON PIPE WITH 2 3/8" BRASS CAP IN PLACE OF FOUND STONE.

MONUMENTS AND ACCESSORIES FOUND: CONDITION AND SOURCE

20"x11"x7" STONE 1 FOOT BELOW THE SURFACE.

FND. A 2 3/8" BRASS CAP STAMPED AS BELOW.

FROM WHICH:

- A 5/8" IRON REBAR WITH PLASTIC CAP #951 BEARS N 89°53'51" E 12.68 FEET.
- A 5/8" IRON REBAR WITH PLASTIC CAP #951 BEARS S 0°12'50" W 23.55 FEET.
- A 5/8" IRON REBAR WITH PLASTIC CAP #951 BEARS S 89°55'55" W 13.47 FEET.
- AN ALUMINUM TAG STAMPED 951 IN ROUND FENCE POST BEARS S 89°32'41" W 47.79 FEET.

MONUMENT DETAIL

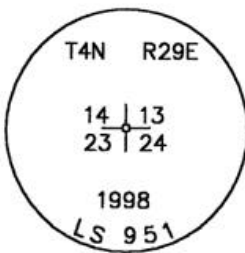

NAD 83/91
 OREGON STATE PLANE
 INTERNATIONAL FEET
 788271.3688
 8548108.7066



SKETCH

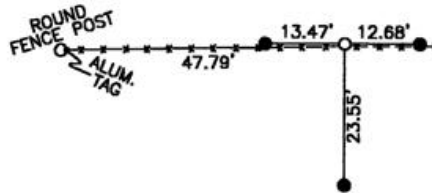

LEGEND:

● 5/8" IRON REBAR

MONUMENT SET (PROCEDURES AND DESCRIPTION)

NEW ACCESSORIES FROM WHICH

LOCATION AND COMMENTS

IN A FENCE LINE 100'± EAST OF AN IRRIGATION CANAL

COMPASS DEC.

FIRM/AGENCY
 EDWARDS SURVEYING
 P.O. BOX 763
 HERMISTON, OREGON 97838

PARTY CHIEF
 D. EDWARDS

NOTES

WITNESS
 CURTIS J FAVOREL

RECEIVED BY

Umatilla County Surveyor

Date 12-01

Rec'd By KE

No. 01-213-9

SURVEYOR'S SEAL

REGISTERED
 PROFESSIONAL
 LAND SURVEYOR

G. Dennis Edwards

OREGON
 JULY 16, 1971
 G. DENNIS EDWARDS
 9 5 1

RENEWS 12/31/2001