

OREGON CORNER RESTORATION FORM

COUNTY: Umatilla DATE: 06/29/06

CORNER DESIGNATION: 3N31, X-25, The East One-Quarter Corner of Section 36.

PREVIOUS RENEWALS/SURVEYS ETC.: Corner was originally established by D.S. Payne, under Contract No. 100, dated August 1, 1861. Record states: Set charred stake with mound, trench & pits as per insts. for 1/4 section corner.

Note: This corner bordered a former military base, (now Pendleton Airport lands). The Dept. of the Army or Corps of Engineers probably made surveys in the area, but after researching City of Pendleton and Airport drawings and blueprints, we were not able to find any useful information.

MONUMENT AND ACCESSORIES FOUND: None.

MONUMENT MARKING DETAIL:

T3N
R31E R32E
 $\frac{1}{4}$
S36 | S31
2006
PLS 1106

MONUMENT SET:

I reestablished this corner position at the extended intersection of a old fence line running South with the centerline of Stage Gulch Road, running East. This point is also in line with the centerline of Stage Gulch Road running North and Don Pinkertons gravel drive access going West. I considered reestablishing this corner by single proportion measurement, but the position by single proportion measurement fits no improvements and would place a portion of the old City landfill on the wrong side of the line. At the reestablished corner position, set a 2 3/8" brass cap on 1 1/4" by 30" galvanized iron pipe with cap 8" below gravel road surface. Monument marked as shown in Monument Marking Detail.

From which:

A 5/8" x 24" iron rebar with 1 1/4" red plastic cap marked "OR PLS 1106 WA PLS 17372" bears North 64° East, 75.9 feet.

A 5/8" x 24" iron rebar with 1 1/4" red plastic cap marked "OR PLS 1106 WA PLS 17372" bears South 01° West, 47.9 feet. (located 6" North of a railroad tie fence corner post. Attached witness post sign to railroad tie post.)

An existing 5/8" iron rebar with 1 1/4" red plastic cap marked "ORLS 1815 WALS 18731" bears South 07 1/2° West, 37.7 feet. (no survey record found for this monument—suspect its a survey control point).

A 5/8" x 24" iron rebar with 1 1/4" red plastic cap marked "OR PLS 1106 WA PLS 17372" bears North 13° West, 21.4 feet. (located 4" East of a "Private Road" sign.)

Attached bearing object signs to iron rebar accessories.

LOCATION AND COMMENTS: Corner is located in the center of a East-West private gravel drive, in line with old fence extending South.

OREGON STATE PLANE COORDINATE, North Zone, NAD 83(91), International Feet:

N = 744115.20
E = 8618217.81

FIRM: William R. Wells, PLS
P.O. Box 1696
Pendleton, OR 97801

COMPASS DECLINATION: 18° East

Surveyor's Seal

Witnesses: Jason Wells, LSIT
/3N31X25

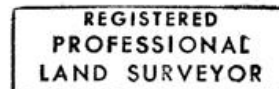

Will. R. Wells

