

OREGON CORNER RESTORATION FORM

COUNTY: Umatilla DATE: 04/07/06

CORNER DESIGNATION: 3N31, V-25, The Northeast Corner of Section 36.

PREVIOUS RENEWALS/SURVEYS ETC.: Corner originally established by D.S. Payne, under Contract No. 100, dated August 1, 1861. Record states: Set charred stake with mound, trench and pits as per insts. for corner to Secs. 25 & 36 T. 3 N., R. 31 E., and Secs. 30 & 31, T. 3 N., R. 32 E.

MONUMENT AND ACCESSORIES FOUND: None. Held the intersection of centerline of Stage Gulch Road North and South, and a good field berm extending West as the best remaining evidence of original corner position.

MONUMENT MARKING DETAIL:

T3N
R31E | R32E
S25|S30
S36|S31
2006
PLS 1106

MONUMENT SET:

At reestablished corner position, set a 2 3/8" brass cap on 1 1/4" x 30" galvanized iron pipe with cap 12" below gravel road surface. Monument marked as shown in monument marking detail.

From which:

A 5/8" x 24" iron rebar with 1 1/4" red plastic cap marked "OR PLS 1106 WA PLS 17372" in fence line bears North 23 1/2° East, 42.9 feet.

A 5/8" x 24" iron rebar with 1 1/4" red plastic cap marked "OR PLS 1106 WA PLS 17372" in fence line bears North 50 1/2 ° East, 21.0 feet. Set steel fence post with witness sign attached, by this accessory.

A 5/8" x 24" iron rebar with 1 1/4" red plastic cap marked "OR PLS 1106 WA PLS 17372" in fence line bears South 48 1/2 ° East, 19.1 feet.

A 5/8" x 24" iron rebar with 1 1/4" red plastic cap marked "OR PLS 1106 WA PLS 17372" in fence line bears South 20 1/2 ° East, 41.8 feet.

Attached bearing object signs to all iron rebar accessories.

LOCATION AND COMMENTS: Corner is located at the intersection of centerline of Stage Gulch Road and a field berm extending West.

OREGON STATE PLANE COORDINATE, North Zone, NAD 83(91), International Feet:

N = 746787.60
E = 8618208.62

FIRM: William R. Wells, PLS
P.O. Box 1696
Pendleton, OR 97801

COMPASS DECLINATION: 18° East

Surveyor's Seal

Witnesses: Jason Wells, LSIT

/3N31V25

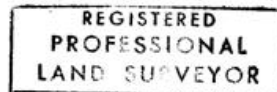

William R. Wells

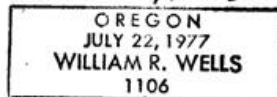

renews 6-30-08