

OREGON CORNER RESTORATION FORM

COUNTY: Umatilla DATE: 04/04/06

CORNER DESIGNATION: 3N31, N-13, The Northeast Corner of Section 21.

PREVIOUS RENEWALS/SURVEYS ETC.: Corner originally established by D.S. Payne, under Contract No. 100, dated August 1, 1861. Records state: Set charred stake with mound, trench and pits as per insts. For corner to Secs. 9 & 10, 15 & 16.

MONUMENT AND ACCESSORIES FOUND: None.

MONUMENT MARKING DETAIL:

T3N R31E
S16|S15
S21|S22
2006
PLS 1106

MONUMENT SET:

Held the intersection of centerline of Moore Road running North-South, and a field berm extending East and West as the best remaining evidence of original corner. At reestablished corner position, set a 2 3/8" brass cap on 1 1/4" x 30" galvanized iron pipe with cap 12" below gravel road surface. Monument marked as shown in monument marking detail.

From which:

- A silver Deep-1 magnet buried 24" below ground level bears North 48° East, 40.9 feet.
- A blue Deep-1 magnet buried 24" below ground level bears South 41° East, 41.8 feet.
- A purple Deep-1 magnet buried 24" below ground level bears South 41 1/2° West, 44.9 feet.
- The center, at ground level of 2"x2" square steel tubing curve sign, bears North 88° West, 41.6 feet. Attached witness sign to this curve sign.
- Buried bearing object signs with all magnets and attached bearing object sign to the curve sign.

LOCATION AND COMMENTS: Corner is located at the intersection of Moore Road and field berm East and West.

OREGON STATE PLANE COORDINATE, North Zone, NAD 83(91), International Feet:

N = 757319.13
E = 8602210.61

FIRM: William R. Wells, PLS
P.O. Box 1696
Pendleton, OR 97801

COMPASS DECLINATION: 18° East

Surveyor's Seal

Witnesses: Jason Wells, LSIT

/3N31N13

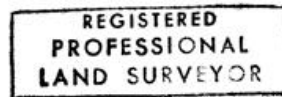

Will R. Wells

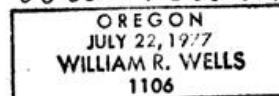

renews 6-30-08