

OREGON CORNER RESTORATION FORM

T2N R30E A1

Section 6, Township 2N, Range 30E,
 County Umatilla, Date December 14, 2004.

Township corner common to Townships 2 and 3 North
 Ranges 29 and 30 East, W.M., Umatilla County, Oregon.

Previous Renewals / Surveys, etc.

- Condition Report
- Not Found
- Remonumented
- Unrecorded
- Surveyed in
- Referenced out

The corner was originally set by David P. Thompson under Contract No. 83 dated July 22, 1859. His record Reads: Set post for corner to Tps. 2 & 3 North of Ranges 29 & 30 East in mound of earth with pits, trench & c., as per instructions. This corner was tied and used by the O.W.R. & N Railroad as seen in the map filed in Plat Book 2, Page 43, of the Umatilla County Plat records. This map was filed as part of the deed from William F. Woodstock recorded in Book 36, Page 110 of the Umatilla County Deed Records. The Railroad map indicates that railroad work first began in this area in 1881.

Monument and accessories found: (Condition and source)

None. The point falls in a plowed field approximately 4' west of a buried irrigation main.

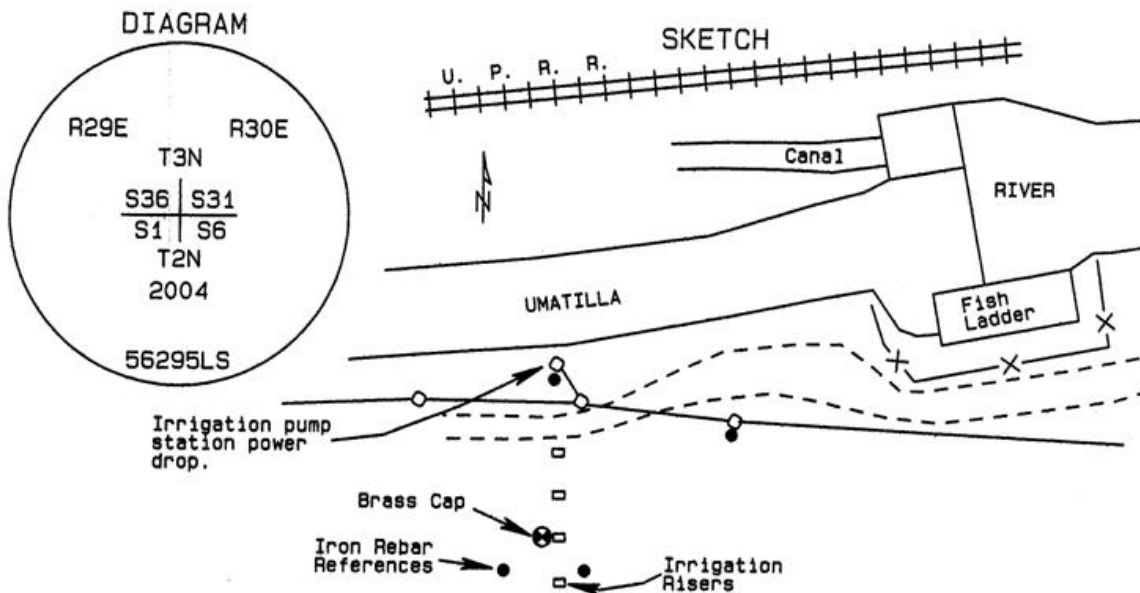

Monument and accessories set: (Procedures and description)

I set a 1 3/8" x 30" galvanized iron pipe with an attached 2 3/8" brass cap stamped as shown in the diagram above 54" in the ground.

For references I set four 5/8" x 24" iron rebars with 1.25" orange plastic caps attached stamped WTS and 56295LS as described below:
 an iron rebar bears N42°50'17"E 243.16 feet at the base of a power pole;
 an iron rebar bears N8°25'49"W 150.44 feet at the base of a power meter post;
 an iron rebar bears S61°43'25"E 27.54 feet 24" below the surface in a plowed field;
 an iron rebar bears S31°35'10"W 27.72 feet 24" below the surface in a plowed field;
 Survey control was established with a Trimble R7/R8 system using static surveying procedures. The monument and references were set with a Geodimeter System 600 electronic total station using radial methods. Bearings and distances are Grid.

Location and Comments
 SPC Oregon North, NAD 83-91
 Northing = 740,663.43 ift
 Easting = 8,554,266.13 ift

Witnessed By:
 David L. Haddock
 Mrs. Joy Markum

RECEIVED BY:
 Umatilla County Surveyor

Date: 5-05
 Rec'd By: KK
 No. 05-11-C

Compass Declination

Surveyor's Seal

Firm / Agency
 Witness Tree Surveying
 P.O. Box G
 Pilot Rock, OR 97868
 Party Chief
 Stephen K. Haddock, PLS

REGISTERED
 PROFESSIONAL
 LAND SURVEYOR

Stephen K. Haddock
 OREGON
 JULY 9, 2001
 STEPHEN K. HADDOCK
 56295LS

RENEWAL DATE 6-30-05