

# CORNER RESTORATION FORM

Township 3N Range 29E & 30E Section 13 & 18 County UMATILLA

State OREGON Date 9-15-2014 Number L-1

- Condition Report Only
- Not Found
- Renewed
- Surveyed In
- Referenced

Corner Designation : 1/4 SECTION 13 & 18

Previous Renewals ORIGINAL SOURCE OF CORNER

UNDER GLO CONTRACT #84 BY N. GATES DATED  
JULY 22, 1859 SET POST  
   
 

Accessories Found:

NONE

BASIS OF BEARINGS, NAD 83/91 OREGON STATE PLANE  
 COORDINATES NORTH ZONE:

NORTHING: 759226.403  
 EASTING: 8553918.299

### MONUMENT DETAIL

Found  Set

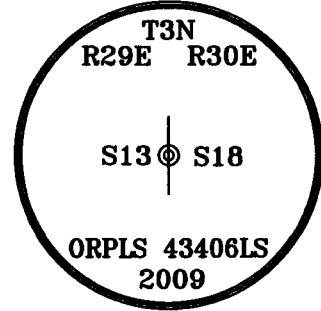

### Monument & Accessories Set (Procedure and Description)

FOUND 2 1/2" BRASS CAP BELOW ROAD GRADE, COVERED WITH A WHITE PIECE OF TIN TO PROTECT THE BRASS CAP. PER SURVEY No. 11-14-R.

### Sketch of Monument, Accessories and General Area

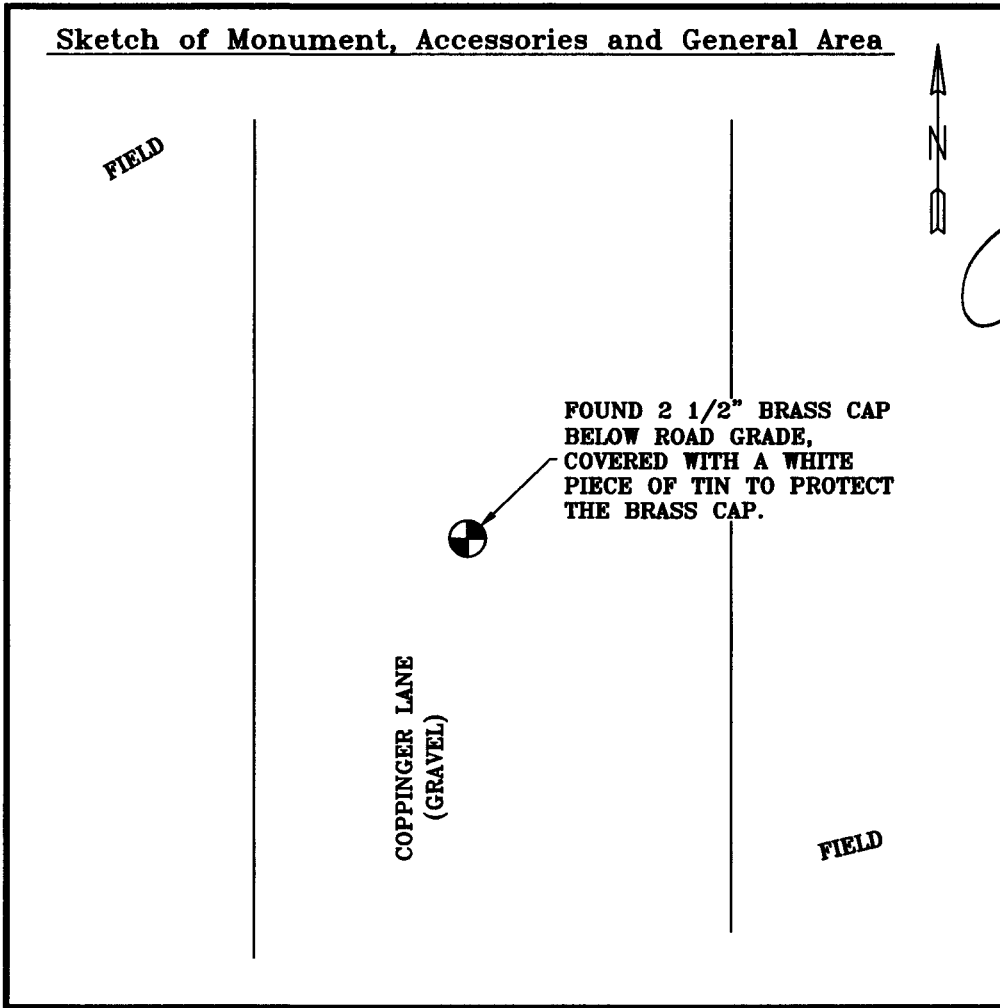

**REGISTERED PROFESSIONAL LAND SURVEYOR**

*James King*

**OREGON**  
MAY 10, 2011  
**LANCE CLARK KING**  
61420

**RENEWS: 6/30/2017**

**Agency:**  
CK3, LLC  
945 W. ORCHARD  
HERMISTON OREGON 97838  
OFFICE: 541-567-2345  
FAX: 541-567-2305  
WEB: CK3LLC.NET  
Field Book # 0-298

**COUNTY SURVEYOR RECORDING INFO**

Received *May Robert*

Filed 6/12/2015

Survey No. 15-050-C

Drawing No. C-853

Index No. L-1