

**OREGON CORNER RESTORATION FORM**

COUNTY: Umatilla. DATE: 03/22/23.

CORNER DESIGNATION: L-5, the East Quarter Corner of Section 18, Township 3 North, Range 28 East, W.M.

PREVIOUS RENEWALS/SURVEYS ETC: Corner was originally established by N.H. Gates under Contract No. 84, dated July 22, 1859. Gates set a post in earth mound. Survey No. Q-506-A set a 1/2" pipe for the corner monument. Survey No. 00-33-B reestablished the corner point with reference to other monuments set on Survey No. Q-506-A and set a brass cap on iron pipe monument.

MONUMENT AND ACCESSORIES FOUND: Found 2 1/2" brass cap on galv. iron pipe with brass cap 4" below ground line. Brass cap is stamped as shown in Monument Marking Detail.

MONUMENT MARKING DETAIL:

T3N R28E  
1/4  
S18|S17  
2000  
PLS 852

MAINTAINED CORNER MONUMENT:

Existing accessories are as reported on Corner Record No. 00-33-B Corner Record. At the request of landowner Scott Madison, I did not set any witness or bearing object signs as the corner and accessories are near Mr. Scott Madison's residence.

Courses to corner accessories from Corner Record No. 00-33-B are true bearings and distances.

LOCATION AND COMMENTS: The corner monument is located 2' South of the North top of bank of an irrigation ditch.

OREGON STATE PLANE COORDINATE, North Zone NAD 83(91), International Feet Units:

N: 758303.31  
E: 8495147.81

FIRM: Wells Surveying  
P.O. Box 1696  
Pendleton, OR 97801

Surveyor's Seal

\3N28L-5

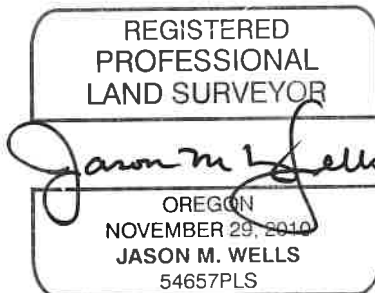

RENEWS: 6.30.24

24-004-C