

**OREGON CORNER RESTORATION FORM**

COUNTY: Umatilla. DATE: 03/21/23.

CORNER DESIGNATION: J-23, the North Quarter Corner of Section 13, Township 3 North, Range 28 East, W.M.

PREVIOUS RENEWALS/SURVEYS ETC: Corner was originally established by N.H. Gates under Contract No. 84, dated July 22, 1859. The corner area was surveyed through on Survey No. 262 and 357, found in Record of Private Survey Books but no monument is reported as set or found. The corner was reestablished by single proportion measure on Survey No. 06-415-B. A brass cap on iron pipe monument was set for the corner.

MONUMENT AND ACCESSORIES FOUND: Found 2 1/2" brass cap on pipe, 8" below the surface of a chip sealed road, Per Survey No. 06-415-B. The rebar monument 20' North of the brass cap was not found. The brass cap is stamped as shown in Monument Marking Detail.

**MONUMENT MARKING DETAIL:**

T3N R28E  
S12  
1/4 -----  
S13  
.2006  
PLS 951

**MAINTAINED CORNER MONUMENT:**

**New accessories:**

- A 5/8"X24" rebar with blue plastic cap marked "Wells Surveying 54657PLS" bears N 73°56'58" E, 70.87', in East-West fence line. Wired bearing object sign to the rebar.
- A 5/8"X24" rebar with blue plastic cap marked "Wells Surveying 54657PLS" bears S 78°43'58" E, 81.18', Set 1' West of UEC power pole. Attached bearing object sign to the power pole.
- A 5/8"X24" rebar with blue plastic cap marked "Wells Surveying 54657PLS" bears S 49°42'11" W, 33.83', in East-West fence. Wired bearing object sign to the rebar.
- A 5/8"X24" rebar with blue plastic cap marked "Wells Surveying 54657PLS" bears N 61°16'23" W, 36.20', at railroad tie gate post in East-West fence line. Nailed bearing object sign and witness post sign to the railroad tie gate post.

Courses to corner accessories are State Plane Grid bearings and distances.

LOCATION AND COMMENTS: The corner monument is located in Andrews County Road.

OREGON STATE PLANE COORDINATE, North Zone NAD 83(91), International Feet Units:

N: 761131.15  
E: 8518918.52

FIRM: Wells Surveying  
P.O. Box 1696  
Pendleton, OR 97801

Surveyor's Seal

\3N28J-23

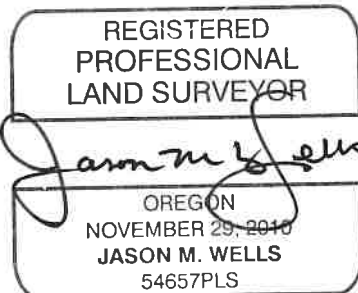

RENEWS: 6!30!24

24-004-C