

OREGON CORNER RESTORATION FORM

COUNTY: Umatilla. DATE: 02/13/23.

CORNER DESIGNATION: A-15, the North Quarter Corner of Section 3, Township 3 North, Range 28 East, W.M.

PREVIOUS RENEWALS/SURVEYS ETC: Corner was originally established by N.H. Gates under Contract No. 84, dated July 22, 1859. Gates set a post in earth mound. Survey No. 253 reestablished this corner and set a stone, 18"X9"X8" in 1907. Survey No. S-156-C reestablished the corner and remonumented with a brass cap on galv. iron pipe monument in 1980. Subsequent record surveys have used the brass cap monument. The corner monument was maintained under Survey No. 19-080-C and a new Corner Record recorded.

MONUMENT AND ACCESSORIES FOUND: Found 2 1/2" brass cap on galv. iron pipe monument, 4" above ground level, stamped as shown in Monument Marking Detail.

MONUMENT MARKING DETAIL:

T4N R28E
1 S34
4 S3
T3N R28E
1980
PLS 933

MAINTAINED CORNER MONUMENT:

New accessories:

A 5/8"X24" rebar with blue plastic cap marked "Wells Surveying 54657PLS" bears S 09°01'00" W, 62.75', at top of bank on North side of ditch access road. Wired bearing object sign to rebar. Set steel fence post with Witness Post sign 1'+/- North.

Accessories per Corner Record filed with 19-080-C are intact as stated.

Courses to corner accessories are State Plane Grid bearings and distances.

LOCATION AND COMMENTS: Corner falls 90' Northerly of the ditch access road on the North side of the ditch, in unfarmed brushy area.

OREGON STATE PLANE COORDINATE, North Zone NAD 83(91), International Feet Units:

N: 771719.74
E: 8508104.29

FIRM: Wells Surveying
P.O. Box 1696
Pendleton, OR 97801

Surveyor's Seal

\3N28A-15

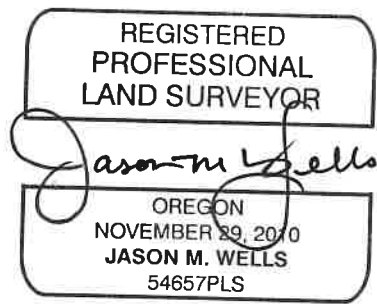

RENEWS: 6!30!24

24-004-C