

OREGON CORNER RESTORATION FORM

Section 3 Township 3N Range 28E
 County Umatilla Date: 06-14-02

Corner Designation: 3N28A15

_____x_____	Condition Report Only
_____	Not Found
_____	Re-monumented
_____	Unrecorded
_____x_____	Surveyed In
_____	Referenced Out

Previous Renewals / Surveys, etc.
 Corner was set by survey S-156-C.

Monument and Accessories Found: (condition and source)
 Found a brass capped monument as described below.

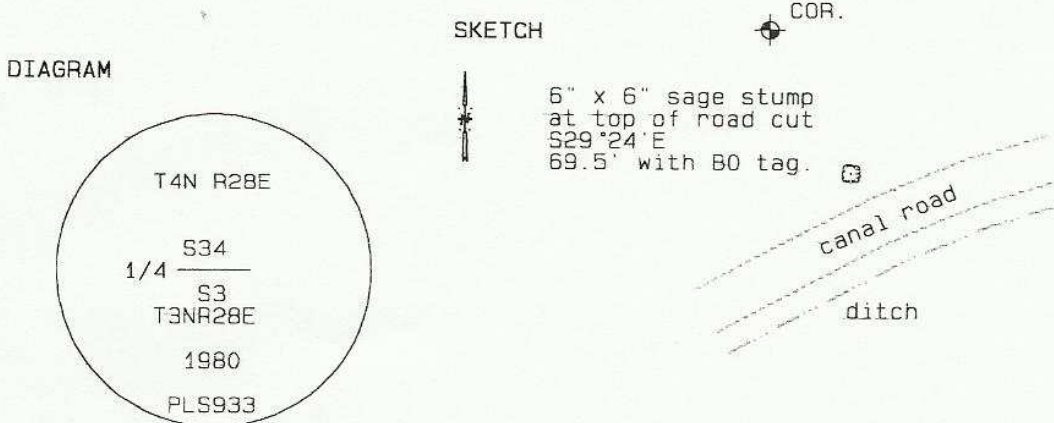

MONUMENT (S) AND ACCESSORIES SET (Procedures and Description)

None.

REFERENCES SET:

None.

Made GPS tie to TRI Station	Oregon State Plane Coord. - North Zone
Stanfield East Base.	Northing 771719.72
Latitude 45°46'37.80722"N	Easting 8508104.34
Longitude 119°18'02.32371"W	Ortho Height 621.26
NAD 83 (1991)	Ellipsoidal Height 551.42

Location and Comments Compass Declination Surveyors Seal

From the junction of I84 and Highway 207, go south 0.6 miles. Take a road through a stock yard east 0.1 mile and follow the road along the northerly side of an irrigation ditch northeasterly. Follow this road 1.8 miles. The corner location is marked by a B0 sign on a sage stump at the top of a small cut.

RECEIVED BY: _____ Firm / Agency

REGISTERED
PROFESSIONAL
LAND SURVEYOR

David L. Haddock

Date: 7-02
 Rec'd By: KE
 No. 02-185-g

Haddock Surveying
 P. O. Box 1574
 Pendleton, OR 97801
 (541) 276-2174

OREGON
JULY 12, 1968
DAVID L. HADDOCK
852