

CERTIFIED RECORD OF LAND CORNER MONUMENTATION

HISTORY OF ORIGINAL CORNER ESTABLISHMENT:

Corner originally established by John A. Hurlburt under GLO contract Number 201, dated August 5, 1873. Surveyor General record states:
Set basalt stone 18x12x3 inches 8 inches in ground, from which;
A 7" Pine bears N45°E, 3 lks.
A 8" Pine bears S59°E, 21 lks.
A 12" Pine bears S52°W, 33 lks.
A 10" Pine bears N58°W, 18 lks.

Survey 11-82 states finding 18x12x3 stone.

No record of subsequent monumentation found in Union County survey records

DESCRIPTION OF CORNER EVIDENCE FOUND:

Found stone 18x15x2 basalt stone buried 8 inches, 2 chiseled marks were visible on the south edge of the stone.

See Union County Survey Number 043-1995.

DESCRIPTION OF MONUMENT AND ACCESSORIES I ESTABLISHED TO PERPETUATE THE ORIGINAL LOCATION OF THIS CORNER:

At the position of the found stone, I set a 2½"x30" aluminum pipe with aluminum cap marked as shown, 23 inches in the ground with collar of stone. I buried the original stone on the east side of the new monument running north and south as it was found, from which;

NEW BEARING TREES:

A 9" White Fir bears N30°E, 66.43 feet, marked T1S R36E S32 BT.
A 12" White Fir bears S23°E, 39.61 feet, marked T2S R36E S5 BT.
A 12" Ponderosa Pine bears S23°W, 20.57 feet, marked T2S R36E S6 BT.
A 9" Ponderosa Pine bears N60°W, 30.35 feet, marked T1S R36E S31 BT.

I hereby certify that the corner was monumented on October 6, 1995.
Witness: Mark Durbin, Jeff Madsen

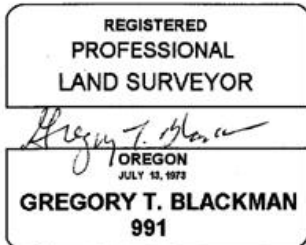
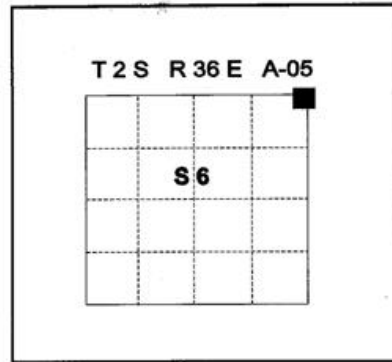

Renewal Date: December, 31 1995

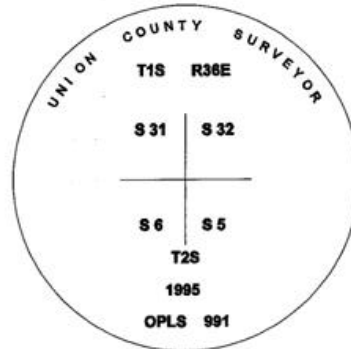

I used a steel tape and magnetic compass in the establishment of the new accessories. I used 18° East declination, the distances are to a 60d spike driven into the right side of the root crown of the bearing tree.

RECEIVED BY
Umatilla County Surveyor
Date 12-95
Rec'd By KR
No. 95-212-C

A-05