

History of original corner establishment:

In 1882, Rufus S. Moore under GLO Contract No. 451 set post 4 ft. long, 4 ins. sq. two ft. in ground for cor. to sec. 16,17,20,21 marked T2S R35E S16 on NE, T2S R35E S17 on N.W., S20 on S.W. and S21 on S.E. faces with 3 notches on S and 4 notches on E edges.

- From which: A Fir 10" in dia. bears N52°W 59 lks. dist., marked T2S R35E S17 BT.
- A Pine 24" in dia. bears S19°E 149 lks. dist., marked T2S R35E S21 BT.
- A Fir 22" in dia. bears N54°E 102 lks. dist., marked T2S R35E S16 BT.
- A Pine 22" dia. bears S53°W, 53 lks. dist., marked T2S R35E S20 BT.

No records on file with Umatilla County Surveyor of any remonumentation.

Description of corner evidence found:

Found 3" brass cap stamped:

Set at record data from original evidence.

Found original SE BT, a P. Pine 31" dia. alive with healed over blazes and scar. Found down and dead 20" Fir with open blazes but scribing is burnt off for N.E. BT. Found rotted stump lying loose on ground for NW BT with faint "BT" marks visible. These original BT's fall at record bearings and distances from monument found to be set in 1968.

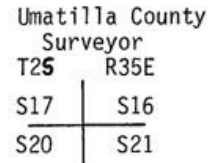

New BT's set in 1968:

- A 14" P. Pine bears S54°E 7.7 ft., visible scribing 2S R36E S21 BT. Tree is dead.
- A 14" Lodge Pine bears S44°W 46.4 ft., visible scribing T2S R35E S20 BT. Tree is dead.
- A 14" Doug. Fir bears N43°W 12.5 ft., visible scribing BT. Rest has healed over. Tree in good condition.
- A 9" White Fir bears N8°E 62.5 ft., visible scribing BT, rest healed over. Tree in good condition.

Description of monument and accessories established to perpetuate the original location of this corner:

We mark new BT's as follows:

- A 12" Doug. Fir bears S81°E 104.0 ft., scribed T2S R35E S21 BT.
- A P. Pine 8" bears S10°W 76.3 ft. scribed T2S R35E S20 BT.

Attached brass washer, PLS 1099 to foot blaze of new BT's. Attached all signs and painted BT's per Standard Specifications for Cadastral Surveys, Region 6, Oct., 1979.

Corner is set in scattered trees 7' east of dirt road.

Compass Declination: 18½° E

I hereby certify the above described corner monument and/or accessories was established as described on July 2, 1981.

Witness: L. Huntsman
R. Orton



Office of..... Surveyor..... County of..... Umatilla.....
 State of..... Oregon..... I hereby certify that the within instrument was filed in this office
 for record on the 30th day of September, 1982
 David Krumbein by Betty Shaltz
 (COUNTY OFFICIAL) (DEPUTY)

Form R6-7100-57 (9/71)

RECEIVED BY
 Umatilla County Surveyor
 Date 9-82
 Rec'd by BLS
 No. 82-103-R