

History of original corner establishment:

Original corner established by Rufus S. Moore on September 29, 1882, under contract number 451 as follows:

Set a post for the corner from which:
A 5" fir bears S52°E, 18 links (11.88 feet).
A 8" fir bears S45°W, 27 links (17.82 feet).

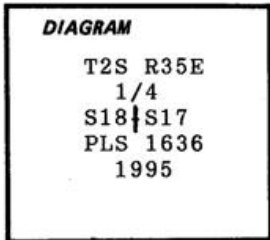

In October of 1917, GLO surveyor L. E. Wilkes perpetuated this corner under Group Number 38, as follows:

The corner post is badly decayed. Set a basalt stone, 18" x 12" x 10", 12" into the ground at the exact corner point. Stone is marked "1/4 18" on west and "17" on east face, from which:
A 6" fir bears S50°E, 18 links (11.88 feet).
A 10" fir bears S47°W, 27 links (17.82 feet).

Description of corner evidence found:

A basalt stone, 18" x 12" x 10", is loosely set in the ground. The stone is marked "1/4 18" on one face and "17" on the opposite face, from which:

A 8" Fir snag with a healed blaze opened to scribe, "S", bears S50°E, 11.9 feet.

A 23" fir with a nearly healed blaze, with scribes visible, is down. Root hole bears S47°W, 17.8 feet.

Description of monument and accessories established to perpetuate the original location of this corner:

Moving the corner stone aside, I set in it's place a 1" x 30" iron pipe 26" into the ground. A 2 1/2" brass cap attached is marked as shown in the diagram above. I bury the corner stone up-side-down along the west side of the pipe. From which:

A 11" Douglas-fir, scribed "1/4 S17 BT", bears N43°E, 174.9 feet.
A 8" Douglas-fir, scribed "1/4 S17 BT", bears S30° 30'E, 109.4 feet.
A 7" Western Larch, scribed "1/4 S18 BT", bears S42°W, 114.7 feet.
A 12" Western Larch, scribed "1/4 S18 BT", bears N38°W, 91.9 feet.

The new bearing trees are scribed on double blazes and have a 5/8" brass washer, marked "PLS 1636", nailed flush to the lower blaze and have a bearing tree sign nailed above the blazes.

I hereby certify the above corner point was perpetuated as hereon described on October 14, 1995. Magnetic declination: 17°E.

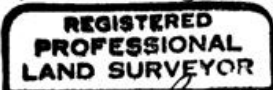

Dennis L. Gaylord

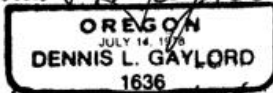

Renews 6/30/97

Office of SURVEY Dept. County of Umatilla
State of OREGON I hereby certify that the within instrument was filed in this office
for record on the 23rd day of October, 1995

(COUNTY OFFICIAL)

(DEPUTY)

Umatilla County
Date 10-95
Filed by KK
No. 95-181-R