

USDA-FOREST SERVICE

Index File No. D-24

T 25 R. 35E

Merid. WILLAMETTE

CORNER RECORD (SEARCH)

(Ref. FSM 7151.4)

R.D. WALLA WALLA

County UNION

N.F. UMATILLA

State OREGON

Tract or Survey No. \_\_\_\_\_

Cor. No. \_\_\_\_\_

CORNER DIAGRAM

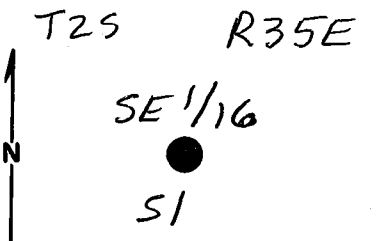

DESCRIBE CORNER MONUMENT ~~FOUND~~ SET BY SURVEY

5/8" x 30" IRON ROD w/ ALUMINUM CAP MARKED "OREGON STATE PARKS"  
7 FOOT FIBERGLASS POST 2 FEET WEST.

DESCRIBE BEARING TREES OR OTHER OFFICIAL ACCESSORIES ~~FOUND~~ SET:

12" DOUGLAS FIR N 37° W, 19.2 ft, "SE 1/16 51 BT RS 691"  
11" WHITE FIR S 85° W, 15.0 ft "SE 1/16 51 BT"

PHOTO IDENTIFICATION DATA

Photo No. \_\_\_\_\_  
Filed At. \_\_\_\_\_  
Object Ident. \_\_\_\_\_  
Ident. By \_\_\_\_\_  
*Signature*

DESCRIBE CORNER LOCATION RELATIVE TO NEAR-BY FEATURES, ALSO HOW TO REACH CORNER

PLANE COORDINATE POSITION DATA

State \_\_\_\_\_ Zone \_\_\_\_\_  
X \_\_\_\_\_  
Y \_\_\_\_\_  
Estab. By \_\_\_\_\_  
*Agency*

Signature JOHN HOLLINGSWORTH Title LS 691 Division \_\_\_\_\_ Headquarters SALEM Date 3-82 FS-7100-52 (3/68)

**CORNER RECORD (PERPETUATION)**

**MONUMENT : DESCRIBE NEW MONUMENT SET, OR WORK DONE TO PRESERVE EXISTING MONUMENT**

**ACCESSORIES : DESCRIBE NEW BT's WITNESS OBJECTS ETC. ESTABLISHED, OR WORK DONE TO PRESERVE EXISTING EVIDENCE**

9

10

Work Done By \_\_\_\_\_ Title \_\_\_\_\_ Date \_\_\_\_\_ State Registration No. or Agency \_\_\_\_\_

Certified Cor. Record Prepared ? Yes No Filed At: \_\_\_\_\_ Date \_\_\_\_\_

11

**REMARKS**

12

Index File No. T. R. M. Tract or Surv. No. Cor. \_\_\_\_\_

13