

Index File No. Z-17

CORNER RECORD (SEARCH)

Tract or Survey No. \_\_\_\_\_

Cor. No. \_\_\_\_\_

Z-17

T 2 S. R. 33 E.

R.D. UKIAH

County Umatilla

Merid. Will.

N.F. Umatilla

State ORE.

CORNER DIAGRAM

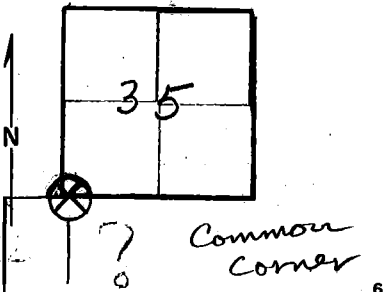

DESCRIBE CORNER MONUMENT FOUND

STONE, 20" X 15" X 5" LYING ON SURFACE OF GROUND. IT IS IN POOR CONDITION, NO MARKINGS WERE FOUND.

DESCRIBE BEARING TREES OR OTHER OFFICIAL ACCESSORIES FOUND

36" D.B.H. POND. PINE BRs. N. 45° E, 30 lks. ALSO FOUND METAL POSTERS.

B.T. HAS BEEN FIRE DAMAGED

PHOTO IDENTIFICATION DATA

Photo No. \_\_\_\_\_

Filed At. \_\_\_\_\_

Object Ident. \_\_\_\_\_

Ident. By \_\_\_\_\_

Signature

7

PLANE COORDINATE POSITION DATA

State \_\_\_\_\_ Zone \_\_\_\_\_

X \_\_\_\_\_

Y \_\_\_\_\_

Estab. By \_\_\_\_\_

Agency

8

DESCRIBE CORNER LOCATION RELATIVE TO NEAR-BY FEATURES, ALSO HOW TO REACH CORNER

Signature

Melvin Christian

Title

Forestry Tech.

Division

Headquarters

UKIAH

Date

10-5-72

7100-52

REV. '65 5

**CORNER RECORD (PERPETUATION)**

**MONUMENT: DESCRIBE NEW MONUMENT SET, OR WORK DONE TO PRESERVE EXISTING MONUMENT**

**ACCESSORIES DESCRIBE NEW BT's WITNESS OBJECTS ETC. ESTABLISHED, OR WORK DONE TO PRESERVE EXISTING EVIDENCE**

Work Done By \_\_\_\_\_ Title \_\_\_\_\_ Date \_\_\_\_\_ State Registration No. or Agency \_\_\_\_\_  
Certified Cor. Record Prepared ? Yes No Filed At: \_\_\_\_\_ Date \_\_\_\_\_

**REMARKS**

Index File No. Z-17 T. R. M. Tract or Surv. No. Cor. \_\_\_\_\_