

CERTIFIED RECORD OF LAND CORNER MONUMENTATION

Index File No. V-5

History of original corner establishment:

In 1890, under G.L.O. contract No. 551, John C. Arnold set 16x8x4 in basalt stone 6 ins. in ground (digging imprac.) for cor. to Secs. 29, 30, 31 & 32, marked 1 notch on S and 5 notches on E., and raised a mound of stone 1 1/2 ft H x 3 1/2 ft Base over cor. on S. hillside. Pits imprac.

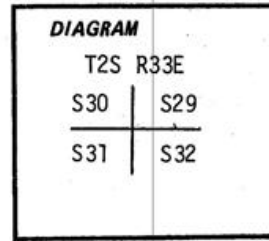

Description of corner evidence found:

At approx. corner location, using terrain calls made to the north-south & east, found stone mound 1 ft high and 4 ft dia. at base with 16"x8"x4" stone lying flat in middle of mound. Visible faint notch on south and 2 notches visible on east sides. Accept location of stone as true corner position based on best available evidence.

Description of monument and accessories established to perpetuate the original location of this corner:

In place of stone set 2 1/2"x30" galvanized pipe with brass cap stamped:

Set pipe 10" in ground with mound of stone to cap; buried the original stone alongside.

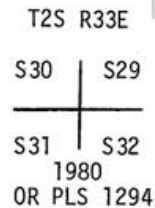

No trees are within limits or practical dist. The steepness of terrain makes it impractical to build mound of stones for bearing objects. Use 3 natural monuments and shoot bearings to them:

- A Lone Tree on top of north-south ridge to the east bears N79°E.
- A Large Rock protruding vertically at west end of large rock outcropping on east-west ridge just south of corner bears S57°E.
- Northend of large rock outcropping on north end of ridge running north-south lying east of corner bears N60°30'E.

Attached 54-4 sign to metal post 6 ft north of corner.

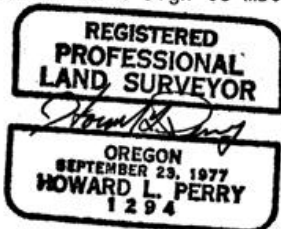

I hereby certify the above corner monument was established as herein described on August 12, 1980.

Witnesses: R. Orton  
L. Huntsman  
D. Allen

Office of.....County Surveyor..... County of.....Umatilla.....  
State of.....Oregon..... I hereby certify that the within instrument was filed in this office  
for record on the.....day of.....December....., 19.....80  
.....David Huntsman..... by.....Betty Shatto.....  
(COUNTY OFFICIAL) (DEPUTY)