

**OREGON CORNER RELOCATION FORM**

Section 33 Township 2S Range 32E  
 County Umatilla Date: April 5, 2007

Corner Designation: 2S32Z11

Condition Report Only  
 Not found  
 Remonumented  
 Unrecorded  
 Surveyed in  
 Referenced out

South Quarter corner to section 33 only, T2S, R32E,  
 W.M., Umatilla County, Oregon.

Previous Renewals / Surveys, etc.

Corner originally set by David P. Thompson under contract No. 106 dated August 16, 1864. His record reads: Set stone, 15 x 12 x 4, for 1/4 sec. Cor. This corner was superceded by George Pershin under contract No. 430 dated March 23, 1882. His record reads: No trace of old cor. Set basalt stone, 20 x 14 x 7 ins., 12 ins. in ground for 1/4 sec.cor., marked 1/4 and X on N. face.

Monument and Accessories found: ( condition and source )

I found the record stone by Pershin lying flat on the ground. The markings on the stone had spalled off and were lying on the ground along side. I also found the original stone by Thompson plainly marked 1/4 set loosely in the ground.

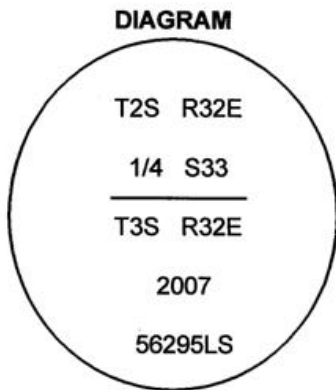

⊕ = 1" Rebar w/AL. Cap  
 • = Rebar Reference

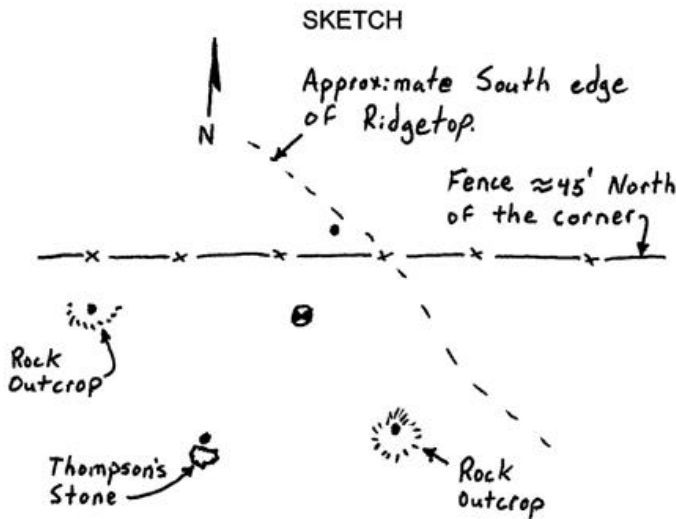

**MONUMENT (S) AND ACCESSORIES SET (Procedures and Description)**

At the position of Pershin's stone I set a 1" x 24" iron rebar with a 2" aluminum cap attached and set the original stone along side and built a mound of stone around the corner.

For references, I set four 5/8" by 20" rebars with 1.25" orange plastic caps stamped WTS and 56295LS as described below:

- an iron rebar bears N7°51'14"E, 58.62 feet;
- an iron rebar bears N78°09'50"W, 122.15 feet in a small rock outcrop;
- an iron rebar bears S17°23'44"E, 46.70 feet in a small rock outcrop;
- an iron rebar bears S27°29'12"W, 78.13 feet along side of Thompson's original stone which I reset to a depth of 12 inches at Thompson's original point.

The monument and references were tied using a Trimble R7/R8 RTK GPS.

Location and comments

Compass Declination

Surveyors Seal

RECEIVED BY:  
Umatilla County Surveyor  
 Date: 6-07  
 Rec'd By: KK  
 No. 07-169-C

Firm / Agency  
 Witness Tree Surveying  
 Address  
 P.O. Box G  
 Pilot Rock, Or. 97868  
 Party Chief  
 Stephen K, Haddock

REGISTERED  
 PROFESSIONAL  
 LAND SURVEYOR

*Stephen K. Haddock*

OREGON  
 JULY 9, 2001  
 STEPHEN K. HADDOCK  
 56295LS

RENEWAL DATE 6-30-07