

R-21

OREGON CORNER RESTORATION FORM

Section 26 Township 2N Range 32 E

County Umatilla Date 1-16-90

CORNER DESIGNATION

- Condition Report Only
- Not Found
- Renewed
- Unrecorded
- Surveyed In
- Referenced Out

Previous Renewals/Surveys, etc. G. Odman, April 1982 County #82-51-C did not find original corner and he used good inter-section of fences to north-south and west.

Monument(s) & Accessories Found: (Condition and Source)

I found the fence corner Odman used and set brass cap using his bearings and distances, which places the corner 6" east of the existing fence corner post.

Monument Detail

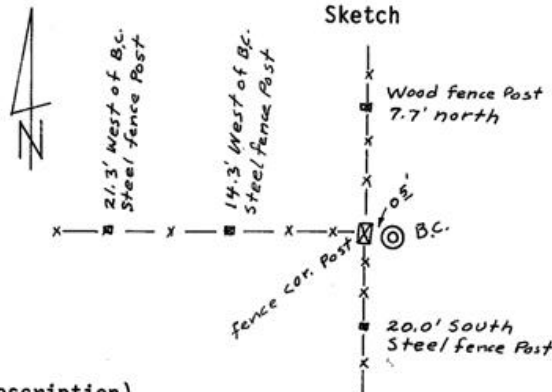
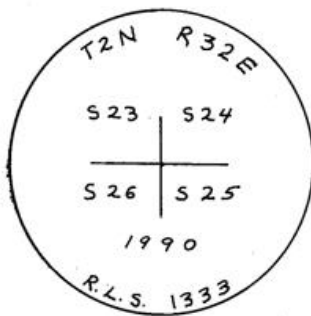

Monument Set (Procedures and Description)

Set 1" x 30" G.I.P. w/flared base and 2 1/2" brass cap 6" above the ground and 6" east of fence corner.

New Accessories

1. Good wood fence post bears North 7.7 ft.
2. Steel fence post bears South 20.0 ft.
3. Steel fence post bears West 14.3 ft.
4. Steel fence post bears West 21.3 ft.

All witness posts have bearing object signs attached.

Location & Comments

Brass cap corner is 6" east of fence corner post. Compass Declination Firm/Agency Don Staebler

Engineer - Surveyor Address 1532 SW 41st St.

Umatilla County Surveyor Pendleton, OR 97801

Date 1-90 Party Chief Don Staebler

Notes

No 90-03-A Witness

Surveyor's Seal

