

OREGON CORNER RESTORATION FORM

Section 15 Township 2N Range 32 EWM

County Umatilla Date 4/89

CORNER DESIGNATION

Initial Point for Youngs 1st and
2nd Additions to the City of
Pendleton - Also 1/4 corner between
Sections 16-15 T2N R32 EWM
Previous Renewals/Surveys, etc.

- Condition Report Only
- Not Found
- Renewed
- Unrecorded
- Surveyed In
- Referenced Out

Monument(s) & Accessories Found: (Condition and Source)

April, 1989 Initial Point for Youngs 1st and 2nd Additions to the City
of Pendleton - Also 1/4 corner between Sections 16-15 T2N R32 EWM.
Existing 2" Iron Pipe apparently removed during construction of a
new fence. This point is also the Initial Point for Blakey Addition to
the City of Pendleton

Monument Detail

Set 5/8" Iron Pin with
Aluminum Cap attached
stamped "City of Pendleton"

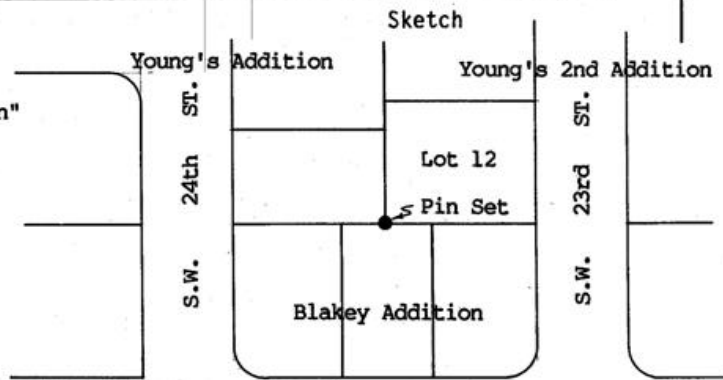

Monument Set (Procedures and Description)

April 1989 Set new 5/8" X 24" Iron Pin with aluminum cap attached
stamped "City of Pendleton". Pin reset from original reference marks
on file with the City of Pendleton.

New Accessories

Location & Comments

Pin located at the S. W. corner of Lot 12 Block 6 of Youngs 2nd Addition to the City of Pendleton

Compass Declination _____
Firm/Agency City of Pendleton
Address 34 S. E. Dorion Pendleton, OR 97801
Party Chief Rick B
Notes _____
Witness Bernard Duby

RECEIVED BY _____
Umatilla County Surveyor
Date 10-92
Rec'd by RR
No. 92-123-R

Surveyor's Seal

**REGISTERED
PROFESSIONAL
LAND SURVEYOR**

Richard A. Bordenkircher

OREGON
JULY 26, 1985
RICHARD A. BORDENKIRCHER
2141