

Form 874-9—Revised May, 1918
U. S. Department of Agriculture
FOREST SERVICE

Umatilla NATIONAL FOREST
CORNERS OF THE PUBLIC SURVEY

T. 1 & 2 S. R. 36 E. Mer.
Section Corner common to Sections

Corner consists of a Mound of rocks in place
State condition Good

Dimensions above ground 12" x 36" x 36" inches.

Sketch grooves, letters, figures, or notches, on proper face or edge.

CARDINAL POSITION				DIAGONAL POSITION			
N	W	S	E	NW	SW	SE	NE

Stake not present.

Mound of _____ is located _____

Pits are located _____
Sketch markings of Bearing Trees (or Rocks) in proper box and fill blanks below, giving bearings from Corner to Trees and Distances in Links.

B. T.			

Species V.P.
Diameter 56"
Bearing N. 60 W.
Distance 2 chs.

Do you believe this to be a genuine Land Office Corner? Yes

If not, why? _____

Charles J. Tucker
(Signature)
Forest Ranger
(Title)
Aug. 9, 1932
(Date)

T. 1825 R. 36 E. Millan to Mer.

(Make sketch of topography near Corner)

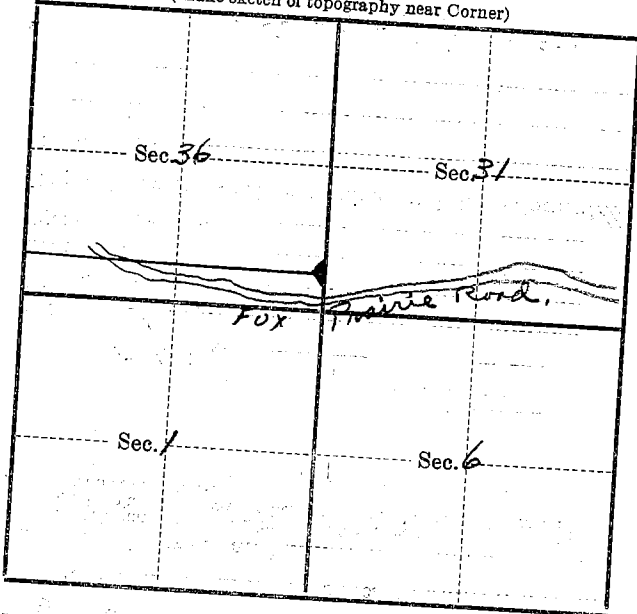

Metal Location Poster is on a Y.P.
tree 10 inches diameter, on the South
side of Corner near road
from which this Corner bears N. 5 W
1 1/2 chains distant.

Give any further facts which will aid in finding this
Corner again.

Section line boards are placed
on tree 5 ft from Fox Prairie
Road.