

95-69A

CERTIFIED RECORD OF LAND CORNER MONUMENTATION

V-1

RESTORED CORNER FOR STATE OF OREGON--DEPARTMENT OF FORESTRY

History of original corner establishment:

Section corner common to Sections 30 and 31 (West end, originally 25, 36, 30 & 31), T1S, R36E, W.M., Umatilla County, Oregon.

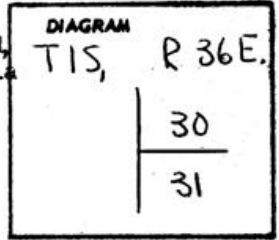

ORIGINAL (1881) and evidence FOUND

Post (hole containing rotted wood found in place) from which a:

- 24" Fir bears S10W 26 lks.; now 12" high rotted stub.
- 12" Tamarack bears S63E 23 lks.; rotted to ground level.
- 14" Tamarack bears N22E 28 lks.; rotted to ground level.
- 24" Fir bears N84W 20 lks.; now 24" by 15 ft. high stub, slab of original face with scribes T1S R35E S25 remaining.

Section corner 25 and 36 bears South 355.1 ft.

~~Description of corner evidence found.~~

Description of monument and accessories I established to perpetuate the original location of this corner

RESTORED

- Set 1/2" x 14" iron rod 12" in ground, and from which a:
 - 26" Fir bears N82 1/2 E 22.8 ft. to face; scribed T1S R36E S30 BT.
 - 10" Fir bears S25E 26.9 ft. to face; scribed T1S R36E S31 BT.
 - 28" Fir bears N20W 41.8 ft. to face; scribed RS 359.

Set 4 x 4 x 48" white painted Cedar post alongside of corner rod. Oregon State Forestry Department metal location poster on 36" Fir S78W 41.7'.

Dated September 17, 1969

Restored by

Present and witnessed by Frank Blizard



Arnold G. Gibson
 NOV 4 1969
 ARNOLD G. GIBSON
 359

Office of County of
 State of I hereby certify that the within instrument was filed in this office
 for record on the day of 19....., at o'clock m., (signed)
 by
 (COUNTY OFFICIAL) (DEPUTY)

Q-16R

RESTORED CORNER FOR STATE OF OREGON--DEPARTMENT OF FORESTRY

History of original corner establishment:

Section corner common to Sections 30 and 31 (West end, originally 25, 36, 30 & 31), T1S, R36E, W.M., Umatilla County, Oregon.

DIAGRAM

ORIGINAL (1881) and evidence FOUND

Post (hole containing rotted wood found in place) from which a:

- 24" Fir bears S10W 26 lks.; now 12" high rotted stub.
- 12" Tamarack bears S63E 23 lks.; rotted to ground level.
- 14" Tamarack bears N22E 28 lks.; rotted to ground level.
- 24" Fir bears N84W 20 lks.; now 24" by 15 ft. high stub, slab of original face with scribes T1S R35E S25 remaining.

Section corner 25 and 36 bears South 355.1 ft.

~~Description of corner evidence found.~~

Description of monument and accessories I established to perpetuate the original location of this corner

RESTORED

- Set $\frac{1}{2}$ " x 14" iron rod 12" in ground, and from which a:
- 26" Fir bears N82 $\frac{1}{2}$ E 22.8 ft. to face; scribed T1S R36E S30 BT.
 - 10" Fir bears S25E 26.9 ft. to face; scribed T1S R36E S31 BT.
 - 28" Fir bears N20W 41.8 ft. to face; scribed RS 359.

Set 4 x 4 x 48" white painted Cedar post alongside of corner rod. Oregon State Forestry Department metal location poster on 36" Fir S78W 41.7'.

Dated September 17, 1969

Restored by

Present and witnessed by Frank Blizard

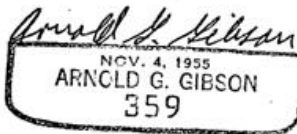
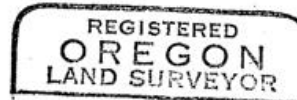

Office of County Surveyor County of Umatilla
State of Oregon, I hereby certify that the within instrument was filed in this office
for record on the 4 day of November, 1969 at o'clock m., (signed)
Ralph Thompson by
(COUNTY OFFICIAL) (DEPUTY)