

USDA-FOREST SERVICE

Index File No. S-6  
T 1S R. 36E  
Merid. Willamette

CORNER RECORD (SEARCH)  
(Ref. FSM 7151.4)

R.D. Pendleton County Umatilla  
N.F. Umatilla State Oregon  
Tract or Survey No. \_\_\_\_\_ Cor. No. \_\_\_\_\_

CORNER DIAGRAM

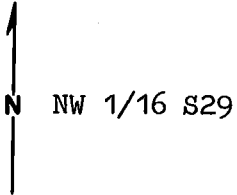

DESCRIBE CORNER MONUMENT FOUND

N/A

DESCRIBE BEARING TREES OR OTHER OFFICIAL ACCESSORIES FOUND

N/A

PHOTO IDENTIFICATION DATA

Photo No. \_\_\_\_\_  
Filed At. \_\_\_\_\_  
Object Ident. \_\_\_\_\_  
Ident. By \_\_\_\_\_  
*Signature*

DESCRIBE CORNER LOCATION RELATIVE TO NEAR-BY FEATURES, ALSO HOW TO REACH CORNER

From its junction with road #3102, follow spur 015 to its end. Corner is Northeast about 700 feet.

PLANE COORDINATE POSITION DATA

State \_\_\_\_\_ Zone \_\_\_\_\_  
X \_\_\_\_\_  
Y \_\_\_\_\_  
Estab. By \_\_\_\_\_  
*Agency*

*Lawrence D. ...* Signature Title Land Surveyor Division \_\_\_\_\_ Headquarters \_\_\_\_\_ Date 10/82 7100-52-(3/68)

**CORNER RECORD (PERPETUATION)**

**MONUMENT: DESCRIBE NEW MONUMENT SET, OR WORK DONE TO PRESERVE EXISTING MONUMENT**

Set 2½"x30" Gal. Iron pipe 14" in ground built mound of stone around monument.

**ACCESSORIES : DESCRIBE NEW BT'S WITNESS OBJECTS ETC. ESTABLISHED, OR WORK DONE TO PRESERVE EXISTING EVIDENCE**

12" D-Fir N11E, 19.6 ft. scribed NW1/16S29BT  
and with a 1" Brass disk stamped PLS 896.

12" D-Fir N82E, 42.1 ft. scribed NW1/16S29BT  
and with a 1" Brass disk stamped PLS 896.

Work Done By Larry D. Bishop Title Surveyor Date 10/82 State Registration No. 896  
or Agency \_\_\_\_\_

Certified Cor. Record Prepared ? Yes No  Filed At: \_\_\_\_\_ Date \_\_\_\_\_

**REMARKS**

Set guard posts North and East with signs 54-9 and 54-2.  
Painted red band and blazes red on BT's - nailed signs 54-9 and BT signs to BT's.