

Index
File No. 0-02

CORNER RECORD (SEARCH)

(Ref. FSM 7151.4)

Tract or
Survey No. _____ Cor.
No. _____

T 15 R. 36 E

R.D. WALLA WALLA County UMATILLA

Merid. WM

N.F. UMATILLA State OREGON

CORNER DIAGRAM

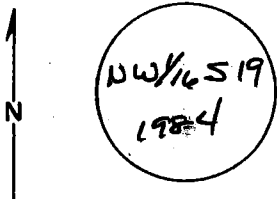

DESCRIBE CORNER MONUMENT FOUND

3 1/4" BLM BRASS CAP ON 2 1/2" IP RISING 5"

DESCRIBE BEARING TREES OR OTHER OFFICIAL ACCESSORIES FOUND

15" DOUG. FIR, B&S NW 1/16 S19 BT,
BEARS N60°W, 47 LKS - 31.0 FT.

15 1/2" W. FIR, B&S NW 1/16 S19 BT,
BEARS N75 1/2°E, 23 LKS - 15.2 FT.

PHOTO IDENTIFICATION DATA

Photo No. _____

Filed At. _____

Object Ident. _____

Ident. By _____

Signature _____

PLANE COORDINATE POSITION DATA

State _____ Zone _____

X _____

Y _____

Estob. By _____

Agency _____

DESCRIBE CORNER LOCATION RELATIVE TO NEAR-BY FEATURES, ALSO HOW TO REACH CORNER

FOLLOW POSTED LINE SOUTH FROM 3033 ALONG
WEST 1/16 11NE SEC 18 TO W 1/16 18
DROPPING INTO
RAVINE 250' WEST FOLLOW SOUTH 1/4 MILE
CORNER IS EAST 75' ABOVE BOTTOM OF RAVINE

Signature
D. DEAN

Title
LS 1848

Division

Headquarters

Date
7-85

CORNER RECORD (PERPETUATION)

MONUMENT: DESCRIBE NEW MONUMENT SET, OR WORK DONE TO PRESERVE EXISTING MONUMENT

NONE

ACCESSORIES : DESCRIBE NEW BT'S WITNESS OBJECTS ETC. ESTABLISHED, OR WORK DONE TO PRESERVE EXISTING EVIDENCE

SET STEEL FENCE POST 3' SOUTH OF CORNER
ATTACHED SIGNS TO POST & BT'S PAINTED RED BANDS

Work Done By B. SUTTON Title SURVEYOR Date 7-85 State Registration No. LS 1840
or Agency

Certified Cor. Record Prepared? Yes No Filed At: _____ Date _____

REMARKS

Index File No. T. R. M. WM Tract or Surv. No.

0-02

T. 13

R. 36E

GPO: 1982 O-382-859

Cor. NW 1/16 519

12

13