

Index
File No. L-21

CORNER RECORD (SEARCH)

(Ref. FSM 7151.4)

Tract or
Survey No. L 21Cor.
No. 1/4T 1 S R. 36 ER.D. PendletonCounty UmatillaMePId. WilliametteN.F. UmatillaState Oregon43

CORNER DIAGRAM

T1S R36E

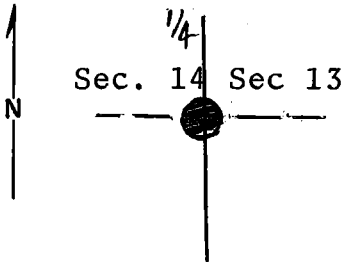

DESCRIBE CORNER MONUMENT FOUND

Brass cap set summer 1972. See back.

DESCRIBE BEARING TREES OR OTHER OFFICIAL ACCESSORIES FOUND

Found 30" pine standing in good condition, grown over blaze clearly visible, bearing S60°W 44.2 ft. from corner position.

Found an 18" pine stump with all scribing clearly visible, bearing S75°E 58.8 ft. dist. from corner.

PHOTO IDENTIFICATION DATA

Photo No. _____

Filed At. _____

Object Ident. _____

Ident. By _____

Signature _____

PLANE COORDINATE POSITION DATA

State _____ Zone _____

X _____

Y _____

Estab. By _____

Agency _____

Signature _____

Title _____

Division _____

Headquarters _____

Date _____

7100-52 (3/68)



4

5

CORNER RECORD (PERPETUATION)

MONUMENT: DESCRIBE NEW MONUMENT SET, OR WORK DONE TO PRESERVE EXISTING MONUMENT

Set a 30x2½" iron pipe with 3" brass cap marked as shown 25 in. in the ground for the 1/4 sec. cor. between sec. 14 & 13 from which a new BT:

ACCESSORIES : DESCRIBE NEW BT'S WITNESS OBJECTS ETC. ESTABLISHED, OR WORK DONE TO PRESERVE EXISTING EVIDENCE

An 18" ponderosa pine bears S44°E 26.8 ft. dist. marked T1S R36E 1/4 S13 BT.

Distance taken to a brass washer in the blaze of the tree. Set a steel fence post approx. 5 ft. East from corner with Forest Boundary sign attached. Used steel tape and magnetic compass with declination = 20° East.

Work Done By D.M. Ferguson Title Land Surveyor Date 7/12/69 State Registration No. 848
or Agency

Certified Cor. Record Prepared Yes No Filed At: Umatilla Co. Courthouse Date 11/16/72

REMARKS