

Index File No. A-9

CORNER RECORD (SEARCH)  
(Ref. FSM 7151.4)

Tract or Survey No. \_\_\_\_\_  
Cor. No. \_\_\_\_\_

T 15 R. 36E R.D. \_\_\_\_\_ County UMATILLA  
Merid. WILL. N.F. UMATILLA State OR

CORNER DIAGRAM

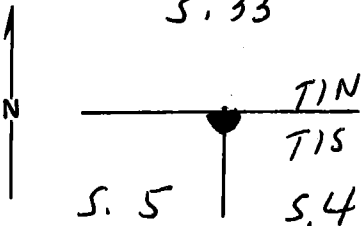

DESCRIBE CORNER MONUMENT FOUND

2 1/2" GALV. IRON PIPE WITH BLM BR. CAP,  
6" ABOVE GROUND, MKD. →

TIN R36E  
S33  
S5 | S4  
CC  
T15 R36E  
1984<sup>2</sup>

DESCRIBE BEARING TREES OR OTHER OFFICIAL ACCESSORIES FOUND

14" FIR, SCRIBED "T15R36E S4 CC BT" BEARS  
S43°E, 106 LKS.  
8" FIR, SCRIBED "T15R36E S5 CC BT" BEARS  
S52°W, 84 LKS.

DESCRIBE CORNER LOCATION RELATIVE TO NEAR-BY FEATURES, ALSO HOW TO REACH CORNER

COR. LIES ON N.E. SLOPE, ABOUT 75' S. OF  
CENTER OF A SHALLOW DRAW, COURSE S.E.

PHOTO IDENTIFICATION DATA

Photo No. \_\_\_\_\_  
Filed At. \_\_\_\_\_  
Object Ident. \_\_\_\_\_  
Ident. By \_\_\_\_\_  
Signature \_\_\_\_\_

PLANE COORDINATE POSITION DATA

State \_\_\_\_\_ Zone \_\_\_\_\_  
X \_\_\_\_\_  
Y \_\_\_\_\_  
Estab. By \_\_\_\_\_  
Agency \_\_\_\_\_

Signature Veter McLeod LS Title \_\_\_\_\_ Division \_\_\_\_\_ Headquarters \_\_\_\_\_ Date 4-22-86 FS-7100-52 (3/68)

CORNER RECORD (PERPETUATION)

MONUMENT: DESCRIBE NEW MONUMENT SET, OR WORK DONE TO PRESERVE EXISTING MONUMENT

ACCESSORIES : DESCRIBE NEW BT'S WITNESS OBJECTS ETC. ESTABLISHED, OR WORK DONE TO PRESERVE EXISTING EVIDENCE

ATTACHED SIGN 54-4 TO BACK OF BT'S  
PAINTED RED BAND AROUND BT'S  
SET STEEL POST ABOUT 4 FT. E. OF CORNER, WITH SIGN 54-9

Work Done By. V. McLIND Title LS Date 6-3-86 State Registration No. or Agency 934

Certified Cor. Record Prepared ? Yes  No  Filed At: \_\_\_\_\_ Date \_\_\_\_\_

REMARKS

Index File No. A-9 T. 15 R. 36E M. WILL. Tract or Surv. No. \_\_\_\_\_ Cor. \_\_\_\_\_

USDA-FOREST SERVICE

Index File No. A-9

CORNER RECORD (SEARCH)

(Ref. FSM 7151.4)

Tract or Survey No. \_\_\_\_\_ Cor. No. \_\_\_\_\_

T 15 R. 36E

R.D. WALLA WALLA County UMATILLA

Merid. WILL

N.F. UMATILLA State OREGON

CORNER DIAGRAM

DESCRIBE CORNER MONUMENT FOUND

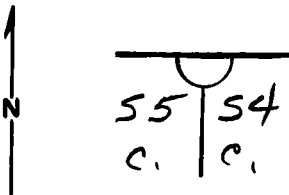

NONE

DESCRIBE BEARING TREES OR OTHER OFFICIAL ACCESSORIES FOUND

NONE - CHAINED 1,240 FT EAST OF 32/33  
& FOUND NUMEROUS LOW CUT STUMPS - NONE WITH AXE MARKS OR HEALED BLAZES, CREEK CALL 1.25 CHAINS EAST FITS WELL.

PHOTO IDENTIFICATION DATA

Photo No. \_\_\_\_\_  
Filed At. \_\_\_\_\_  
Object Ident. \_\_\_\_\_  
Ident. By \_\_\_\_\_  
Signature \_\_\_\_\_

DESCRIBE CORNER LOCATION RELATIVE TO NEAR-BY FEATURES, ALSO HOW TO REACH CORNER

PLANE COORDINATE POSITION DATA

State \_\_\_\_\_ Zone \_\_\_\_\_  
X \_\_\_\_\_  
Y \_\_\_\_\_  
Estab. By \_\_\_\_\_  
Agency \_\_\_\_\_

Signature Dennis L. Gaylord Title \_\_\_\_\_ Division PLS Headquarters 1636 Date 6-10-81  
7100-52-(3/68)

**CORNER RECORD (PERPETUATION)**

**MONUMENT : DESCRIBE NEW MONUMENT SET, OR WORK DONE TO PRESERVE EXISTING MONUMENT**

**ACCESSORIES : DESCRIBE NEW BT'S WITNESS OBJECTS ETC. ESTABLISHED, OR WORK DONE TO PRESERVE EXISTING EVIDENCE**

Work Done By \_\_\_\_\_ Title \_\_\_\_\_ Date \_\_\_\_\_ State Registration No. or Agency \_\_\_\_\_

Certified Cor. Record Prepared ? Yes No Filed At: \_\_\_\_\_ Date \_\_\_\_\_

**REMARKS**

Index File No. T. R. M. Tract or Surv. No. Cor.

USDA-FOREST SERVICE

Index

File No. A-9

**CORNER RECORD (SEARCH)**

(Ref. FSM 7151.4)

Tract or Survey No. \_\_\_\_\_ Cor. No. A-9

T 1S R. 36E

R.D. Pendleton County Umatilla

Merid. Willamette

N.F. Umatilla State Oregon

**CORNER DIAGRAM**

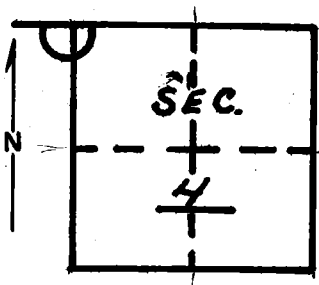

**DESCRIBE CORNER MONUMENT FOUND**

None

**DESCRIBE BEARING TREES OR OTHER OFFICIAL ACCESSORIES FOUND**

Run compass bearing East from found Brass Cap and searched bottom of draw. I found no evidence.

**PHOTO IDENTIFICATION DATA**

Photo No. \_\_\_\_\_

Filed At. \_\_\_\_\_

Object Ident. \_\_\_\_\_

Ident. By \_\_\_\_\_

*Signature*

**PLANE COORDINATE POSITION DATA**

State \_\_\_\_\_ Zone \_\_\_\_\_

X \_\_\_\_\_

Y \_\_\_\_\_

Estab. By \_\_\_\_\_

*Agency*

Signature  
Bill Moore

Title  
Eng. Tech.

Division \_\_\_\_\_

Headquarters \_\_\_\_\_

Date  
6/77

7100-52-(3/68)

**CORNER RECORD (PERPETUATION)**

GPO 902-673

**MONUMENT : DESCRIBE NEW MONUMENT SET, OR WORK DONE TO PRESERVE EXISTING MONUMENT**

9

**ACCESSORIES : DESCRIBE NEW BT'S WITNESS OBJECTS ETC. ESTABLISHED, OR WORK DONE TO PRESERVE EXISTING EVIDENCE**

10

Work Done By \_\_\_\_\_ Title \_\_\_\_\_ Date \_\_\_\_\_ State Registration No.  
or Agency \_\_\_\_\_

Certified Cor. Record Prepared ? Yes No Filed At: \_\_\_\_\_ Date \_\_\_\_\_

11

**REMARKS**

12

Index File No. T. R. M. Tract or Surv. No. Cor. \_\_\_\_\_

13