

USDA-FOREST SERVICE

Index File No. A-03

T 1S R. 36E

Merid. WILLAMETTE

CORNER RECORD (SEARCH)

(Ref. FSM 7151.4)

R.D. WALLA WALLA County UMATILLA

N.F. UMATILLA State OREGON

Tract or Survey No. _____

Cor. No. _____

CORNER DIAGRAM

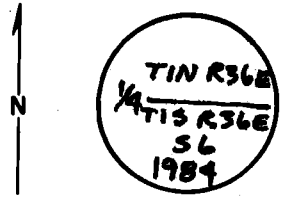

DESCRIBE CORNER MONUMENT FOUND

3 1/4" BLM BRASS CAP
SET Flush in Concrete

DESCRIBE BEARING TREES OR OTHER OFFICIAL ACCESSORIES FOUND

13 1/2" P. PINE, BLAZED & SCRIBED 1/4 S6 BT,
BEARS S40 3/4° W — 122 LKS —
6" PINE, BLAZED & SCRIBED "X" BT,
BEARS S40° E — 234 LKS —

PHOTO IDENTIFICATION DATA

Photo No. _____
Filed At. _____
Object Ident. _____
Ident. By _____
Signature

PLANE COORDINATE POSITION DATA

State _____ Zone _____
X _____
Y _____
Estab. By _____
Agency

DESCRIBE CORNER LOCATION RELATIVE TO NEAR-BY FEATURES, ALSO HOW TO REACH CORNER

In Large Rocky Open Flat
Road 3032 1.3 miles Past Range Line, Posted,
Dirt track Turns Right into Clearing, CAP is
Near North-West Corner

Signature
D. Scott

Title
LS

Division

Headquarters

Date
7/85

7100-52 (3.68)

CORNER RECORD (PERPETUATION)

MONUMENT: DESCRIBE NEW MONUMENT SET, OR WORK DONE TO PRESERVE EXISTING MONUMENT

NONE

ACCESSORIES : DESCRIBE NEW BT'S WITNESS OBJECTS ETC. ESTABLISHED, OR WORK DONE TO PRESERVE EXISTING EVIDENCE

Set Steel Fence Post 4^o WEST in Rock Basket
Attached Signs to Post and BT's
Painted Red Bands on Tree's

Work Done By. D. Scott Title SURVEYOR Date 4/23/85 State Registration No. LS 1844
or Agency

Certified Cor. Record Prepared? Yes No Filed At: _____ Date _____

REMARKS

Index File No.
A-03

T. 15

R. 365 W.M.

Tract or Surv. No.

Cor.

18

13