

OREGON CORNER RESTORATION FORM

Section 6 Township 1S Range 31E
 County Umatilla Date: September 20, 2001

Corner Designation: 1S31A5

North section corner to sections 5 and 6, T1S, R31E, W.M., Umatilla County, Oregon.

Condition Report Only
 Not found
 Remonumented
 Unrecorded
 Surveyed in
 Referenced out

Previous Renewals / Surveys, etc.

The corner was originally set by David P. Thompson under contract No. 106 dated August 16, 1864. His record reads: Set post for corner to secs. 5 & 6 in mound of earth with charred stake, pits, trench, and C. as per instructions. The County surveyor, Aubrey Perry, records a "rock at corner of fence running south" in his survey recorded in Book 2, Page 301 of the Record of Private Surveys dated March, 1919. Mr. Tom Frost set a 5/8" x 30" iron rebar with a 2" Al. Cap at this corner in a partition survey done in June of 2000 for Jennie Lou Blanchet which is as yet unrecorded.

Monument and Accessories found: (condition and source)

The rebar set by Mr. Tom Frost at the fence corner which matches the location called for by Mr. Aubrey Perry in 1919.

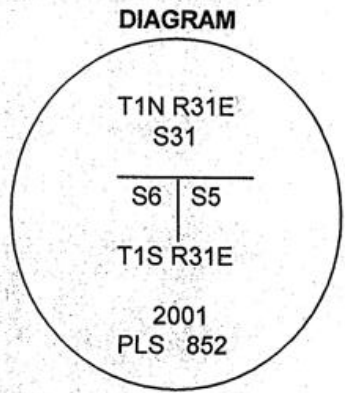

A hand-drawn sketch showing a horizontal 'Base Line'. A north arrow points upwards. A 'Rock Jack' (represented by a square with a cross) is located on the base line. A 'Brass cap' (represented by a circle with a cross) is located directly below the Rock Jack. A 'Rebar reference' (represented by a dot) is located further down from the Brass cap. To the right of the base line, there is a vertical line with several 'x' marks along it. A legend below the sketch identifies the symbols: a square with a cross for 'Rock Jack', a circle with a cross for 'Brass cap', and a dot for 'Rebar reference'.

MONUMENT (S) AND ACCESSORIES SET (Procedures and Description)

The landowner stated that he was going to remove the existing fence and level the plow berms. Therefore, at the position of Mr. Frost's monument, I set a 5/8" x 30" iron rebar 5' below the surface. Over this I set a 30" x 1 1/8" G.I.P. with a 2 1/2" brass cap stamped as shown in the diagram above with the top 30" below the surface.

For references, I set four 5/8" by 24" rebars with 1 1/4" red plastic caps stamped ORLS 852, and WAL5 13922 as described below:

- an iron rebar bears N53°30'30"E, 43.42 feet, 2 feet below the surface;
- an iron rebar bears S31°54'12"E, 42.84 feet, 2 feet below the surface;
- an iron rebar bears S54°19'09"W, 46.53 feet, 2 feet below the surface;
- an iron rebar bears N46°40'54"W, 38.82 feet, 2 feet below the surface;

The monument and references were tied using a LIECA SYSTEM 300 RTK GPS.

Location and comments
 OR SPC Oregon North 1983-91
 N = 677829.83
 E = 8592522.61

Compass Declination

Surveyors Seal

RECEIVED BY:
Umatilla County Surveyor
 Date: 12/20/2001
 Rec'd By: DHE
 No. 01-206-C

Firm / Agency
 Haddock Surveying
 Address
 P.O. Box 1574
 Pendleton, Or. 97801
 Party Chief
 Stephen K, Haddock

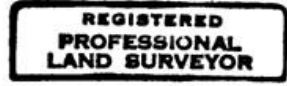

David L. Haddock

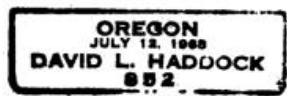

REnews 6-30-03