

USDA-FOREST SERVICE

Index
File No. S-2
T 1N. R. 37E.
Merid. W.M.

CORNER RECORD (SEARCH)

(Ref. FSM 7151.4)

Tract or
Survey No. _____ Cor.
No. _____

R.D. Walla Walla County Umatilla
N.F. Umatilla State OR

CORNER DIAGRAM

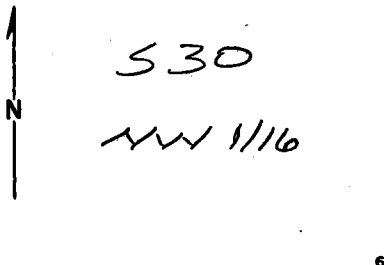

DESCRIBE CORNER MONUMENT FOUND

None

DESCRIBE BEARING TREES OR OTHER OFFICIAL ACCESSORIES FOUND

None

PHOTO IDENTIFICATION DATA

Photo No. _____
Filed At. _____
Object Ident. _____
Ident. By _____
Signature

PLANE COORDINATE POSITION DATA

State _____ Zone _____
X _____
Y _____
Estab. By _____
Agency

DESCRIBE CORNER LOCATION RELATIVE TO NEAR-BY FEATURES, ALSO HOW TO REACH CORNER

ON STEEP SOUTH SLOPE NORTH
OF OLD HOSKINS CABIN

Signature

Michael P. Jefferson PLS.

Title

Division

Headquarters

Date

10/93

FS-7100-52 (3/68)

CORNER RECORD (PERPETUATION)

MONUMENT: DESCRIBE NEW MONUMENT SET, OR WORK DONE TO PRESERVE EXISTING MONUMENT

At a section subdivision as determined by this survey
SET a 3/4" aluminum cap on a 2 1/2" x 30" aluminum pipe
26" in the ground.

TWR 37E
NW 1/16
SEC 7 30
PLS 2535
1993

ACCESSORIES: DESCRIBE NEW BT'S WITNESS OBJECTS ETC. ESTABLISHED, OR WORK DONE TO PRESERVE EXISTING EVIDENCE

25" Douglas fir bears S. ~~25~~^{25-1/2} E., 42.8 feet scribed NW 1/16 S 30 BT
1 1/2" aluminum cap (P.L.S. 2535) on a 5/8" x 24" rebar, S. 58 1/2° W., 16.3 ft.

Work Done By. LeJeune Title PLS Date 9/93 State Registration No. 2535 or Agency

Certified Cor. Record Prepared? Yes No Filed At: _____ Date _____

REMARKS

Index File No.

S-2

T.

1N.

R.

37.E.

M.

W.M.

Tract or Surv. No.

Cor.

12

13